

Technical Information

911 (993)
1/99 1035

1

Binder - Engine

Rear Engine Mount

Vehicle Type: **911 Turbo S (993), 911 Turbo (993) with sport running gear – X73**

Model Year: **1997 (V) – 1998 (W)**

Concern: **New, modified rear engine mount**

Information: Whenever replacing one or both engine mounts on the above-mentioned vehicles, both engine mounts should be updated to a new type engine mount, (part number, 964 375 043 81) if not already equipped.

Note: Always replace both sides when updating a vehicle to the new type mount.

Observe the following when updating a vehicle to the new type engine mounts:

- If performing a first time installation of the new type mount, new 45.5 mm washers (999 025 091 02) should be installed on both sides of the vehicle (Item 3, formerly 34 mm).
- Ensure the proper size hexagon bolt (Item 4) is used during installation. A 125 mm long hexagon bolt (900 082 118 09) M12 x 1.5 x 125 is used on the 911 Turbo S and the 911 Turbo with sport type running gear (X73), versus a 105 mm bolt in standard applications.

Note: Always use the 125 mm long hexagon bolt (900 082 118 09) on the 911 Turbo S and 911 Turbo with sport type running gear (X73)!

- The M12 x 1.5 fastening nut (Item 5, 999 084 215 09) **must always be replaced!**

Tightening torque: Engine mount to engine carrier tightening torque is 63 ft lb (85 Nm).

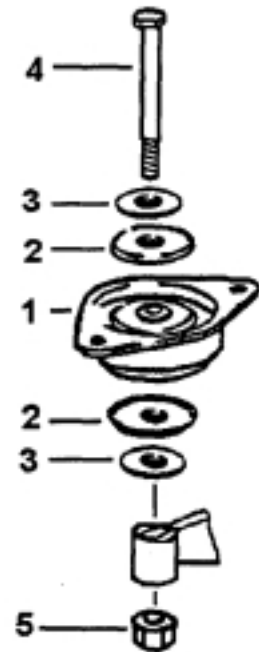

Parts Information:	Part Number	Description
	964 375 043 81	New/Engine mount (item 1)
	999 025 091 02	New/12.7 x 45.5 x 5 mm washer (item 3), qty. 2 per side
	901 305 311 00	Disc (item 2), former part number still valid
	900 082 118 09	M12 x 1.2 x 125 mm hexagon bolt (item 4), former part number still valid
	999 084 215 09	M12 x 1.5 fastening nut (item 5), former part number still valid– Always Replace

Important Notice: Porsche Cars N.A Technical Bulletins are intended for use by professional technicians, not a "Do-it-yourselfer." They are written to inform these technicians of conditions that may occur on some vehicles, or to provide information that could assist in the proper service of a vehicle. Special tools may be required to perform certain operations identified in these bulletins. Use of tools and procedures other than those recommended in these bulletins may be detrimental to the safe operation of your vehicle. Properly trained technicians have the equipment, tools, safety instructions and know-how to do a job properly and safely. If a condition is described, do not assume that the bulletin applies to your vehicle, or that your vehicle will have that condition. See your Porsche Dealer for information on whether your vehicle may benefit from the information. Part numbers listed in these bulletins are for reference only. Always check with your authorized Porsche dealer to verify correct part numbers.

©2000 Porsche Cars North America, Inc.

Dealership	Service Manager	Shop Foreman	Service Technician
Distribution	Asst. Manager	Warranty Admin.	Service Technician
Routing			

The trademarks Porsche®, Targa®, Carrera®, Boxster®, Tiptronic®, Varioam® and the Porsche Crest are registered trademarks of Dr. Ing. h.c.F. Porsche AG and its affiliate, Porsche Cars North America, Inc.