

**ADVERTENCIA**

Al imprimir se corre el riesgo de perder la correcta asignación de las figuras al texto.

- Por motivos técnicos, por el momento no se puede descartar que, aun siendo correcta la imagen que aparezca en la pantalla, al imprimir se pierda la correlación entre el texto y la figura correspondiente.
- Si este error pasara desapercibido, existe el riesgo de que los trabajos no se ejecuten de forma correcta y, por tanto, se produzcan daños personales y materiales.

→ Por ello le rogamos que tras el proceso de impresión compare siempre las copias impresas con la imagen de la pantalla. En caso de error, corrija las copias impresas de forma que se correspondan con el contenido de la imagen de la pantalla.

## 19 58 19 Removing and installing coolant regulator (thermostat) - as of MY 2003

- [Preliminary work](#)
- [Information](#)
- [Removing thermostat](#)
- [Installing thermostat](#)
- [Subsequent work](#)

### Tools

Designation	Type	Number	Explanation	
assembly aid	special tool	9627		

### Preliminary work

#### Preliminary work

1. Drain cooling system. → 193817 Draining and filling coolant (includes bleeding)
2. Remove intake-air distributor. → 244619 Removing and reinstalling intake-air distributor - chapter on "Removing"

### Information

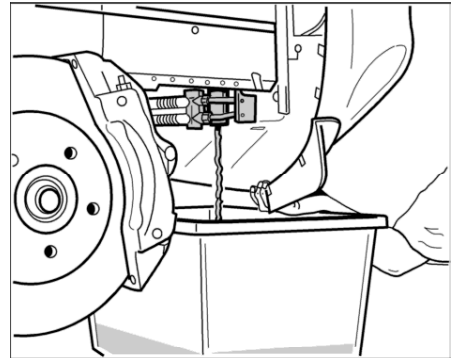

*Draining cooling system*

**Component overview**

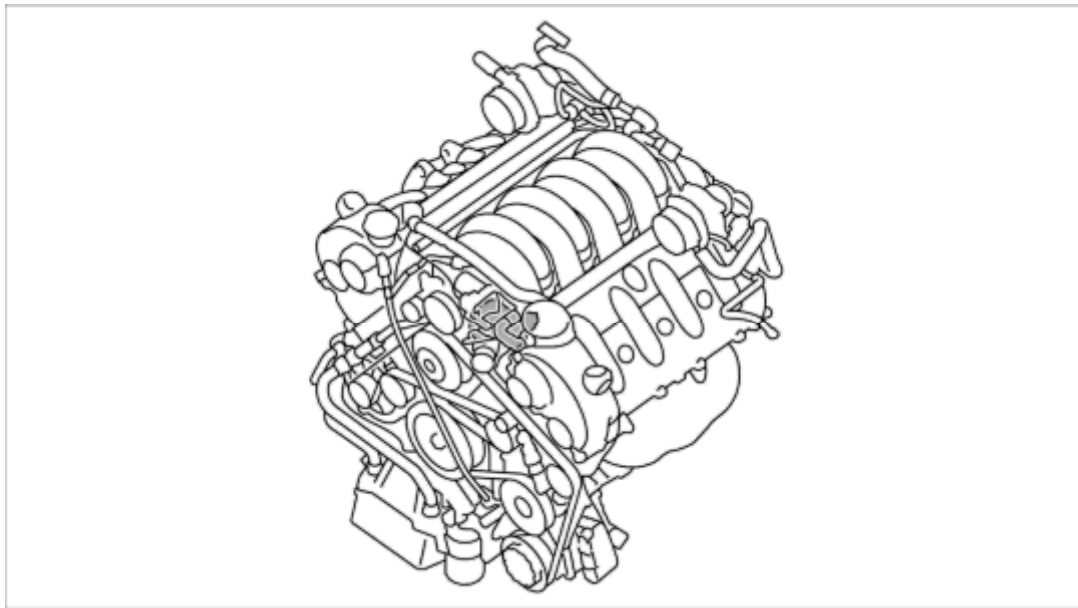

*Install location*

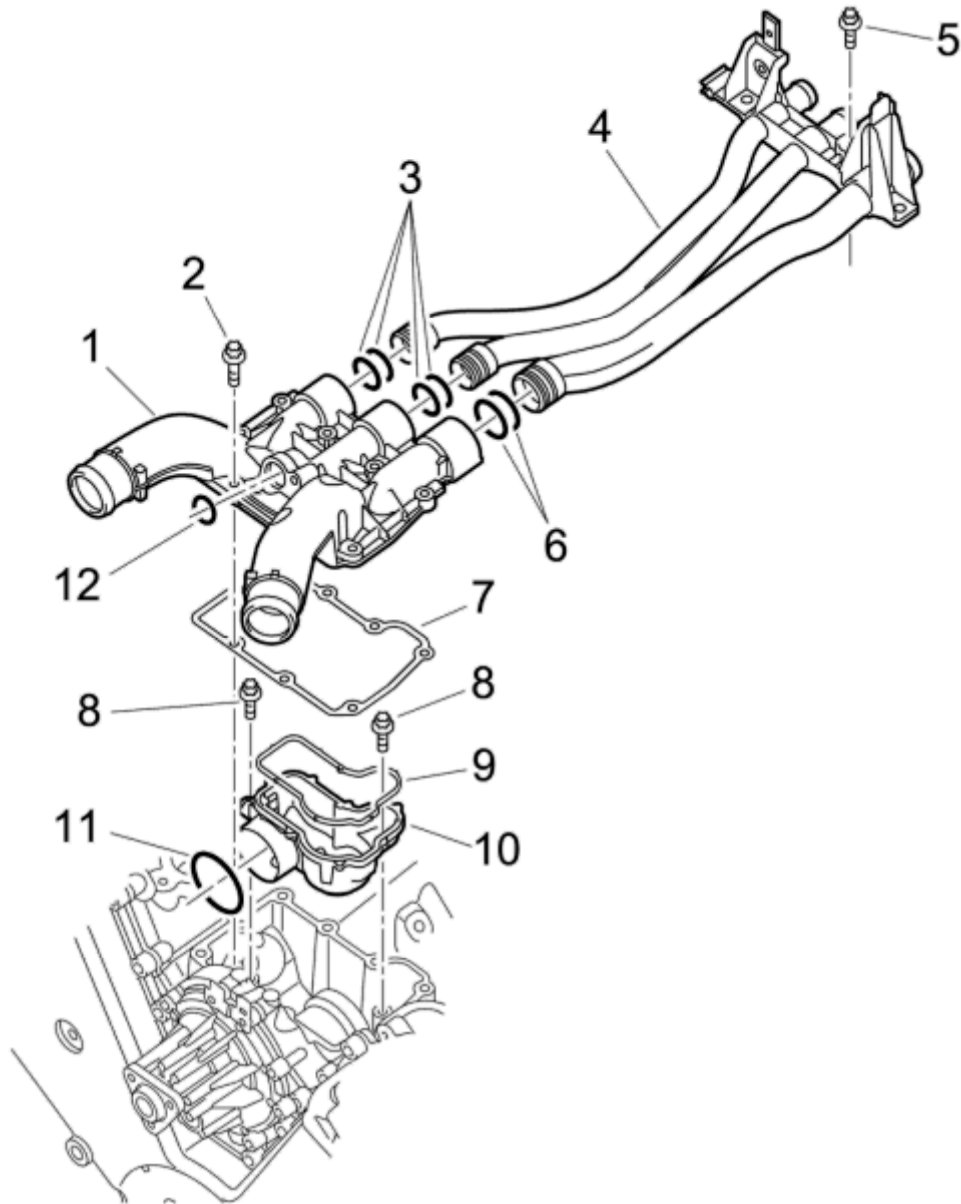

*Component overview*

- 1** - Thermostat housing (observe loosening and tightening sequence)
- 2** - Fastening screw M6 x 25
- 3** - O-rings, 22 x 3, replacing
- 4** - Coolant pipe for heater
- 5** - Fastening screw M6 x 16
- 6** - O-rings, 28 x 3, replacing
- 7** - Seal for thermostat housing; replacing
- 8** - Fastening screw M6 x 16
- 9** - Moulded seal; replacing
- 10** - Thermostat well
- 11** - O-ring, 50 x 3, replacing
- 12** - O-ring, 20 x 2.65, replacing

## Removing thermostat

1. Remove the two coolant lines on the thermostat housing cover. To do this, remove the spring-band clamps and pull off the hoses.

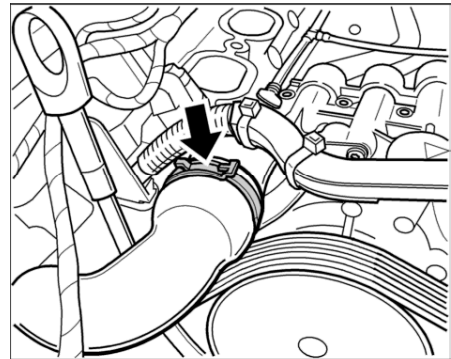

*Spring band clamps for coolant lines on thermostat housing*

2. Pull off the cable duct upwards over the coolant pump.
3. Release the upper fastening screw of the oil dipstick.

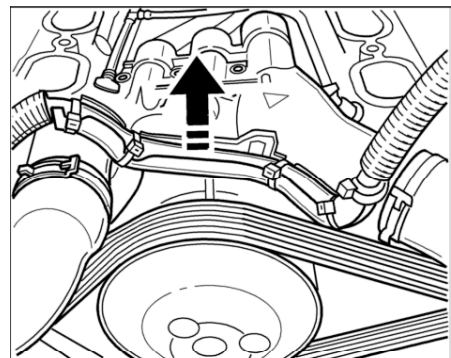

*Cable duct over coolant pump*

4. Loosen the fastening screw on the cable duct.

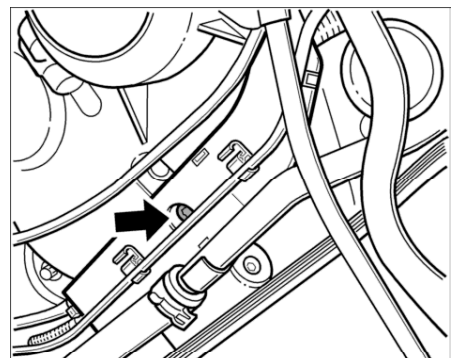

*Fastening screw on the cable duct*

5. Disconnect the coolant outlet on the generator. To do this, open the spring-band clamps and pull off the hose. Collect the draining coolant.
6. Remove the coolant return line on the thermostat housing. To do this, loosen the fastening screw and pull off the line.
7. Disconnect vent line for cylinder heads. To do this, press the ribbed surfaces of the buttons and pull off the plugs.

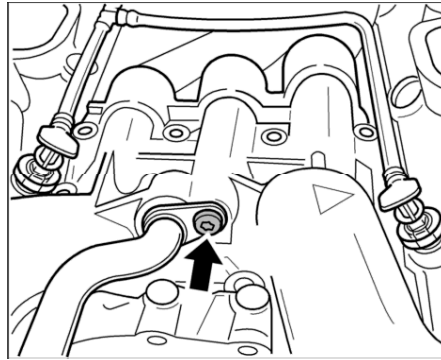

*Fastening screw for coolant return line to thermostat housing*

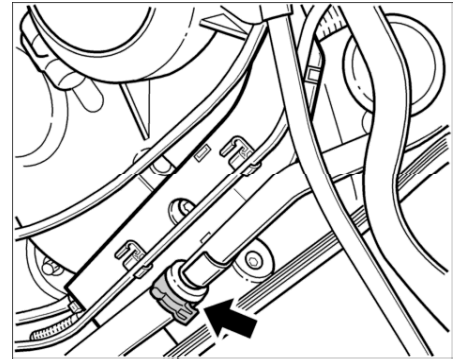

*Spring band clamp for coolant return to generator*

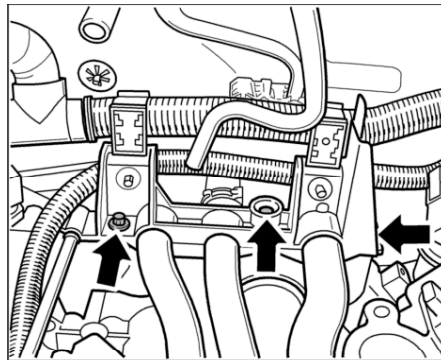

*Fastening screws of heater pipes*

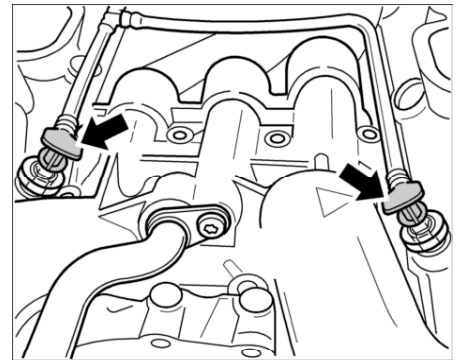

*Button on the vent lines of cylinder heads*

8. Undo the 3 rear fastening screws of the heater pipes.
9. Undo the thermostat housing cover. The sequence shown must be observed when doing so.

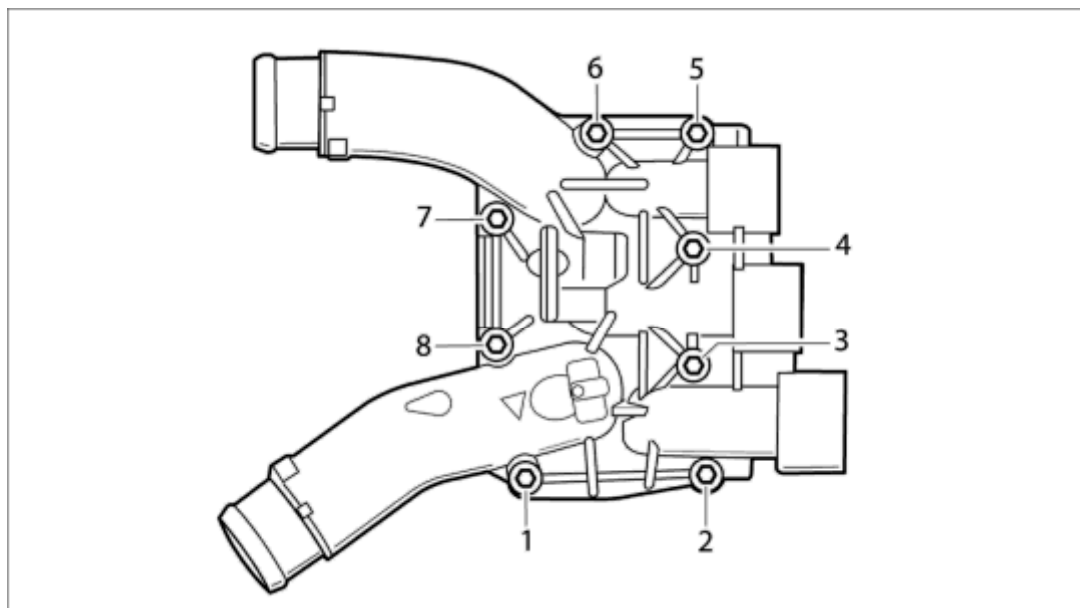

*Loosening sequence for thermostat housing*

10. Lift the housing cover. Remove the thermostat using **assembly aid 9627**.

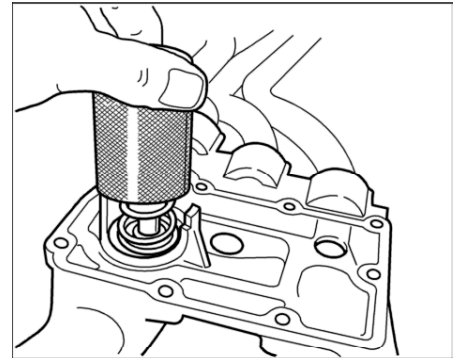

*Removing thermostat with assembly aid*

## Installing thermostat



### Note

- All seals between opened sealing surfaces must be replaced.

1. Insert thermostat in the cover and turn it until the two sheetmetal edges are lying to the left and right of the holder.

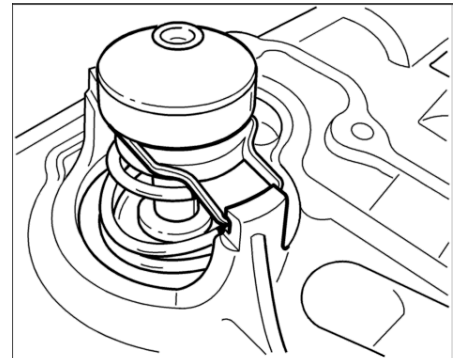

*Inserting thermostat into cover and twisting*

2. Replace inner and outer seal in thermostat housing cover.
3. Position thermostat housing cover and tighten the fastening screws (M6 x 25) according to the sequence shown. → **Tightening torque: 7.5 ftlb.**

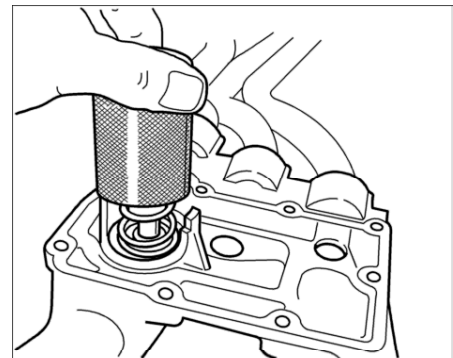

*View shows assembly using the special tool*

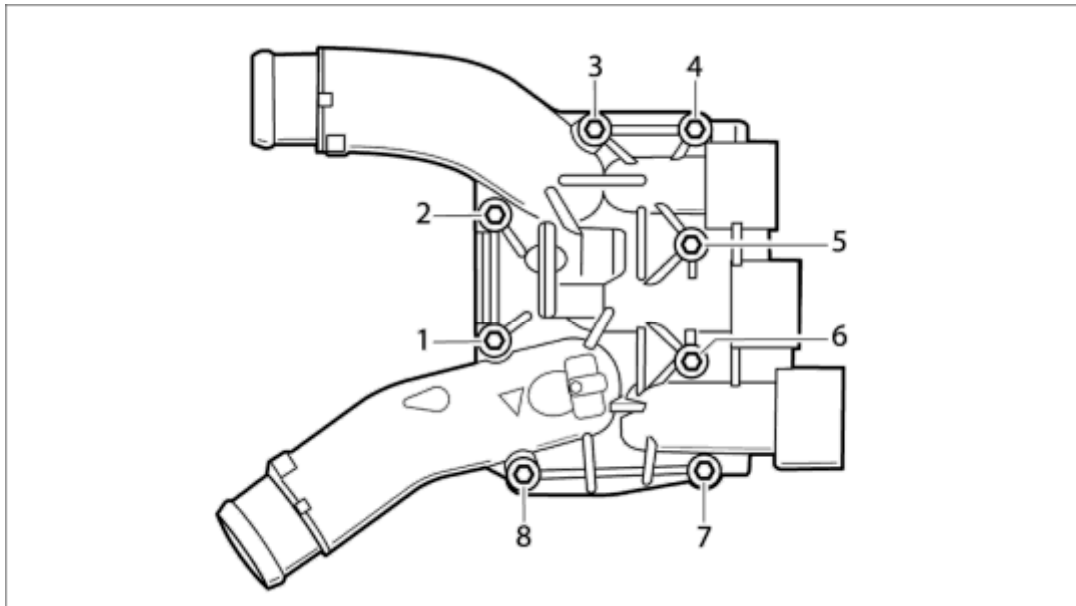

*Tightening sequence for thermostat housing fastening screw*

4. Tighten the three rear fastening screws (M6 x 16) on the heater pipes. → **Tightening torque: 7.5 ftlb.**

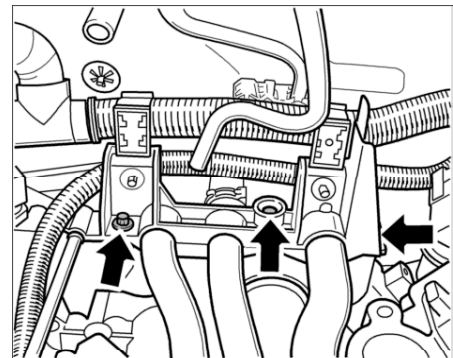

*Fastening screws of heater pipes*

5. Connect vent lines for cylinder heads. The connectors must engage audibly.

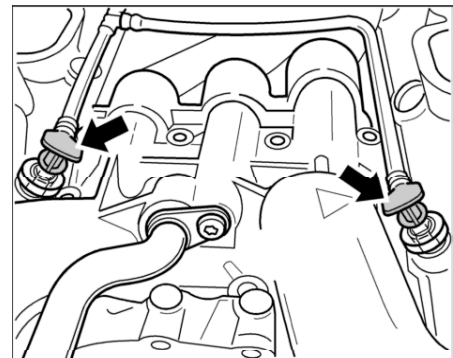

*Vent lines for cylinder heads*

6. Fit coolant line leading to the generator. Insert the line in the thermostat housing cover and tighten the fastening screw. → **Tightening torque: 7.5 ftlb.**
7. Push coolant line onto generator and fit the spring-band clamp.
8. Push the holder onto the timing case cover below the cable duct and tighten the fastening screw. → **Tightening torque: 7.5 ftlb.**

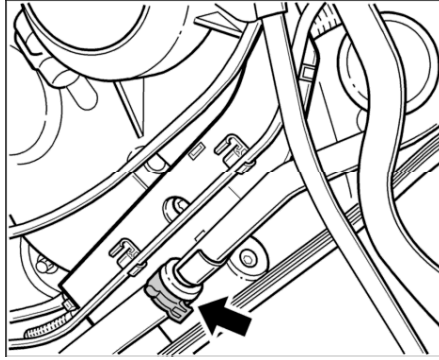

Spring band clamp for coolant line to generator

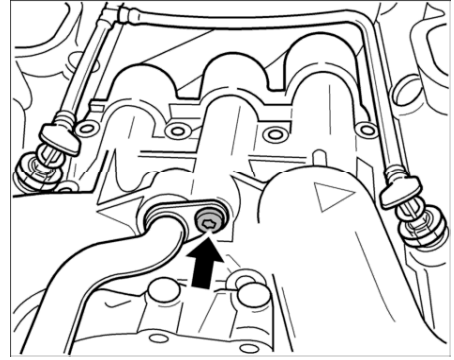

Coolant line to generator

9. Tighten the upper fastening screw of the oil dipstick. → **Tightening torque: 7.5 ftlb.**

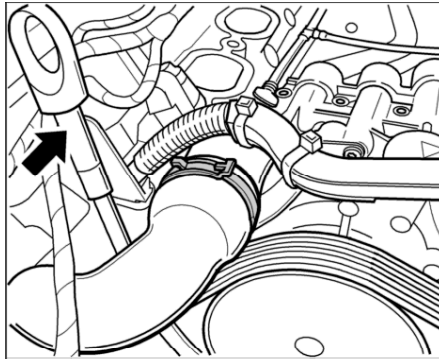

Fastening screw for oil dipstick

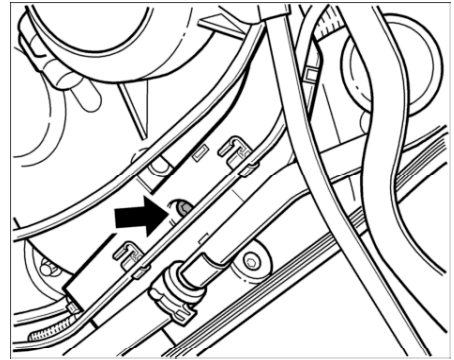

Fastening screw, support to timing-case cover

10. Push the cable duct onto the retaining bracket over the coolant pump.  
 11. Check whether the drive belt is correctly installed.

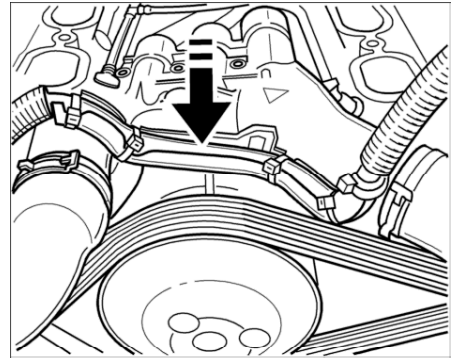

Push the cable duct onto the retaining bracket over the coolant pump.

12. Fit coolant supply and return hose on thermostat housing cover.

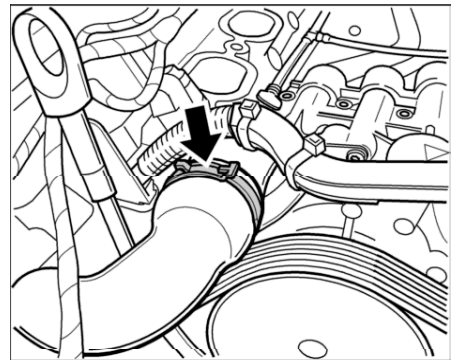

## Subsequent work

### Subsequent work

1. Install intake distributor. → 244619 Removing and reinstalling intake-air distributor - chapter on "Installing"
  2. Fill coolant system and check for leaks. → 193817 Draining and filling coolant (includes bleeding) - chapter on "Filling"
- 

9PAAE1, 9PAAE7, 9PAAF1, 9PAAJ1

as of MY 2003

Country C00, C02, C05, C07, C08, C09, C10, C11, C12, C13, C14, C15, C16, C18, C19, C20, C21, C22, C23, C24, C25, C26, C27, C28, C32, C33, C34, C35, C36, C37, C38, C39, C45, C46, C98, C99