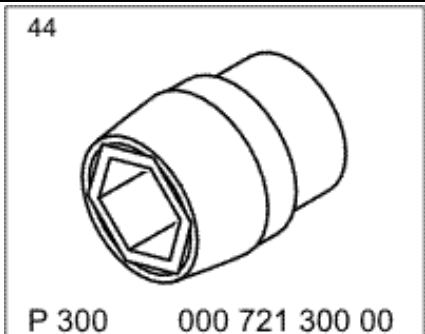

# 20 25 19 Removing and installing carbon canister - as of MY 2005

- Preliminary work for carbon canister
- Removing carbon canister
- Installing carbon canister
- Subsequent work for carbon canister

## Tools

Designation	Type	Number	Explanation	
socket-wrench insert	special tool	300		<div style="border: 1px solid black; padding: 5px;"> <p>44</p>  <p>P 300 000 721 300 00</p> </div>

[top of page](#)

## Preliminary work for carbon canister

### Preliminary work for carbon canister

1. Disconnect ground strap from battery 271000 *Work instructions after disconnecting the battery.*

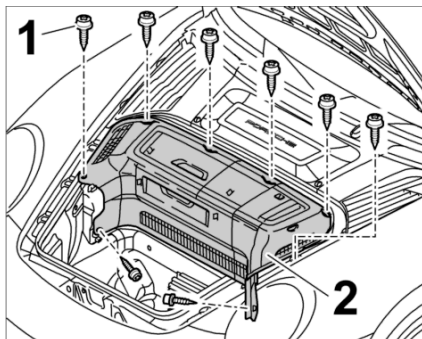

*Luggage-compartment cover*

2. **USA version: Remove** luggage-compartment lining **-2-** by unscrewing the eight sheetmetal screws **-1-** 703019 Removing and installing luggage-compartment cover - chapter on "Removing" [997110 997111 997120 997121 997310 997311 997320 997321] 703019 21 Removing and installing luggage-compartment cover - chapter on "Removing" [997410 997411 997430 997431 997610 997611 997620 997621].

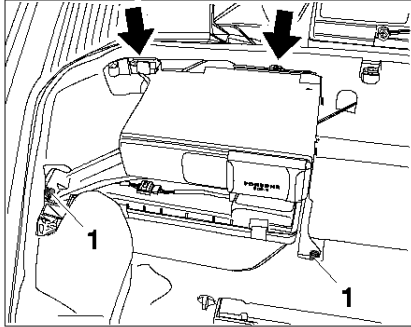

*CD changer support for USA*

3. Unscrew fastening screws for CD changer support **-1-**. The support is also fixed on the body side by two retaining clips **-arrows-**.

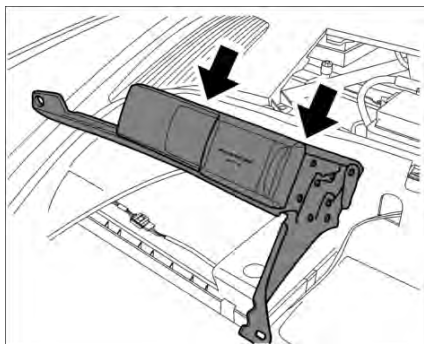

*CD changer support at plenum panel*

4. Lift up support together with CD changer and disengage retaining clips at the plenum panel **-arrows-**.
5. Disconnect cable plug to CD changer.
6. **RoW Version:** Remove right front wheel using **socket-wrench insert 300**. [\\_440519 Removing and installing wheel - chapter on "Removing"](#).
7. Remove rear part of right front wheel housing liner [\\_505619 Removing and installing front wheel housing liner - chapter on "Removing" \[997110 997111 997120 997121 997310 997311 997320 997321\]\\_](#) [505619 Removing and installing front wheel housing liner - chapter on "Removing" \[997621\]\\_](#) [505619 Removing and installing front wheel housing liner - chapter on "Removing" \[997410 997411 997430 997431 997610 997611 997620\]](#).

[top of page](#)

## Removing carbon canister

### Removing carbon canister - RoW Version

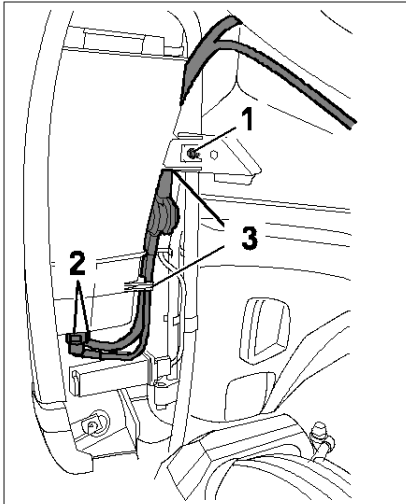

*Carbon canister for RoW*

1. Unscrew collar nut M6 **-1-** . Carefully pull carbon canister out of body mounting points in direction of travel.
2. Release and remove plug-in couplings on the underside of the canister **-2-** . Unclip lines from the mountings on the canister **-3-** .

**Removing carbon canister - USA Version**

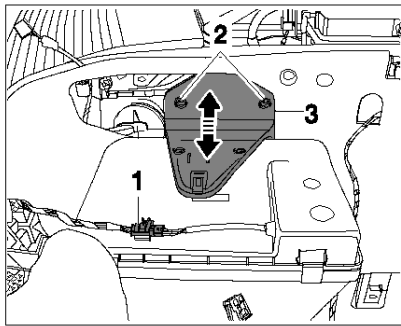

*Carbon canister for USA*

1. Unclip cable plug from canister **-1-** and then disconnect.
2. Unscrew two Torx screws M6 **-2-** from plastic holder for the carbon canister and press holder **-3-** from guide in direction of travel.

## Diagnostic system: reading out fault memory and activating systems

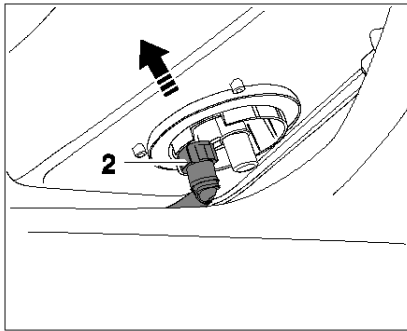

*Small plug-in coupling*

3. Lift carbon canister, release the small plug-in coupling **-2-** and pull it down and off.

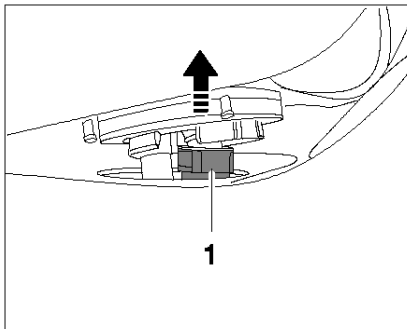

*Large plug-in coupling*

4. Lift carbon canister, release the large plug-in coupling **-1-** and pull it down and off.

[top of page](#)

## Installing carbon canister

### Installing carbon canister - RoW Version

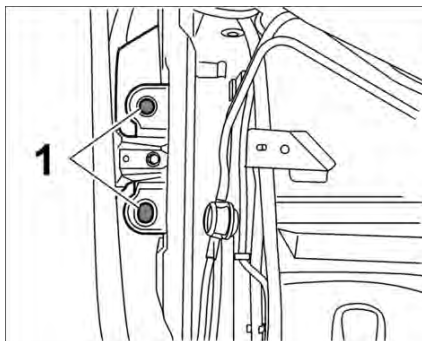

*Body mounting point for RoW canister*

1. Wet rubber sleeves with water. Press canister into the body bores **-1-**.

Removing carbon canister - USA Version

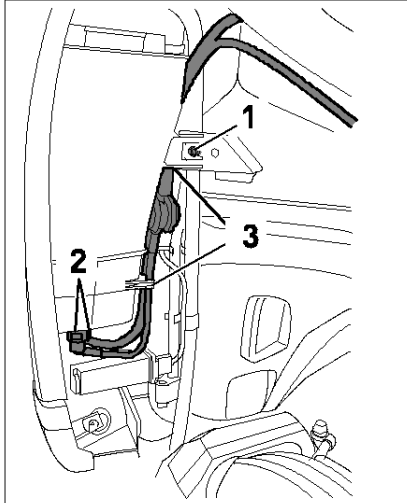

*Carbon canister for RoW*

2. Connect plug-in couplings to the underside of the canister and clip in the lines. Screw in collar nut M6 on the holder and tighten. **Tightening torque: 7.5 ftlb.**

## Installing carbon canister - USA Version

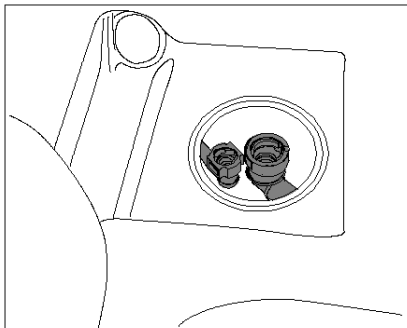

*View of plug-in couplings*

Plug-in couplings in the vehicle

1. Insert canister and connect the plug-in couplings which must engage audibly.

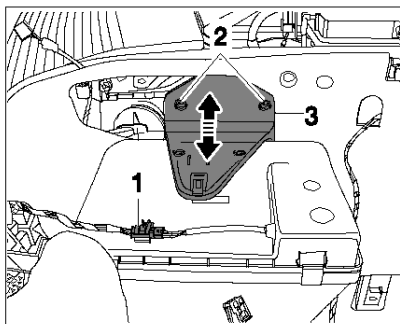

*Carbon canister for USA*

Diagnostic system: reading out fault memory and activating systems

2. Slide plastic holder for the canister **-3-** into the guide and fix to the plenum panel. Screw in two Torx screws M6 **-2-** and tighten. **Tightening torque: 7.5 ftlb.**
3. Connect cable plug and clip into the cable guide on the canister **-1-** .

[top of page](#)

## Subsequent work for carbon canister

### Subsequent work for carbon canister

1. **USA version:** Disconnect cable plug from CD changer.

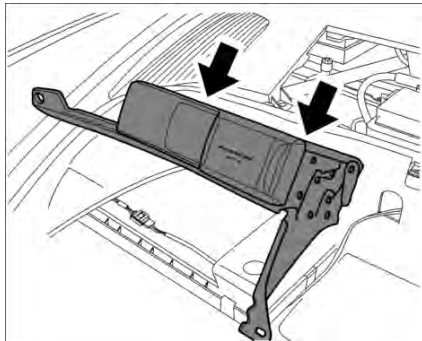

*CD changer support at plenum panel*

2. Engage support together with CD changer on the plenum panel by means of the retaining clips **-arrows-** .

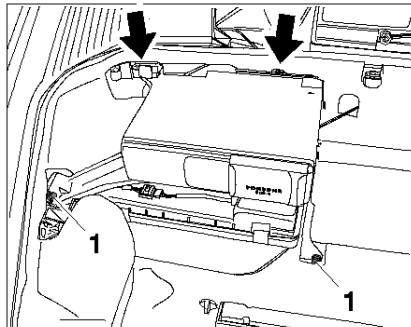

*CD changer support for USA*

3. Screw in and tighten fastening screws M6 **-1-** for CD changer support. **Tightening torque: 7.5 ftlb.**

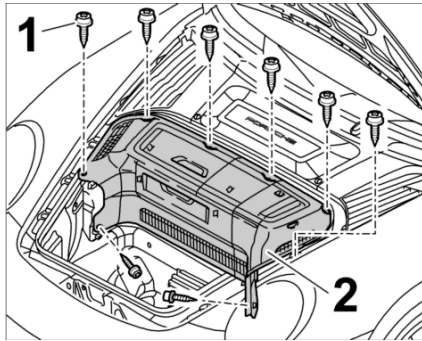

Luggage-compartment cover

4. Install luggage-compartment lining **-2-** by screwing in the eight sheetmetal screws **-1-** 703019 Removing and installing luggage-compartment cover - chapter on "Installing" [997110 997111 997120 997121 997310 997311 997320 997321] 703019 23 Removing and installing luggage-compartment cover - chapter on "Installing" [997410 997411 997430 997431 997610 997611 997620 997621].
5. **RoW Version:** Remove rear part of right front wheel housing liner 505619 Removing and installing front wheel housing liner - chapter on "Removing" [997110 997111 997120 997121 997310 997311 997320 997321] 505619 Removing and installing front wheel housing liner - chapter on "Removing" [997621] 505619 Removing and installing front wheel housing liner - chapter on "Removing" [997410 997411 997430 997431 997610 997611 997620].
6. Fit right front wheel using **socket-wrench insert 300**. 440519 Removing and installing wheel - chapter on "Installing".
7. Connect ground strap to battery 271000 Work instructions after disconnecting the battery.

---

997110, 997111, 997120, 997121, 997310, 997311, 997320, 997321, 997410, 997411, 997430, 997431, 997610, 997611, 997620, 997621

as of MY 2005

Country C00, C02, C05, C07, C08, C09, C10, C11, C12, C13, C14, C15, C16, C18, C19, C20, C21, C22, C23, C24, C25, C26, C27, C28, C32, C33, C34, C35, C36, C37, C38, C39, C45, C46, C98, C99



WARNUNG

**Gefahr des Verlusts der Text-Bild-Zuordnung beim Ausdruck.**

- **Aus technischen Gründen kann derzeit nicht ausgeschlossen werden, dass trotz einwandfreier Darstellung auf dem Bildschirm beim Ausdruck der Zusammenhang von Text und zugehörigem Bild verloren geht.**
- **Wird der Fehler nicht bemerkt, besteht die Gefahr, daß Arbeiten nicht korrekt durchgeführt werden und es dadurch zu Personen- und Sachschäden kommt.**

Vergleichen Sie deshalb nach dem Druckvorgang unbedingt die Ausdrücke mit der Bildschirmdarstellung. Korrigieren Sie die Ausdrücke im Fehlerfall so, daß der Inhalt der Bildschirmdarstellung zutreffend wiedergegeben wird.



WARNING

**Danger of losing text-figure correspondence when printing out.**

Diagnostic system: reading out fault memory and activating systems

- **For technical reasons, it can currently not be ruled out that the correspondence between text and associated figure can be lost when it is printed out, even though the display on the screen is correct.**
- **If the fault is not noticed, there is the danger that work will not be performed correctly which can cause injury and damage.**

Therefore, always compare printouts with the screen display after printing them out. Correct the printouts if they are faulty so that the content of the screen display matches that on the printouts.



#### AVERTISSEMENT

**Risque de perte de la correspondance texte-illustration lors de l'impression papier.**

- **Pour des raisons techniques, il ne peut pas être exclu à l'heure actuelle que, même en cas d'affichage correct à l'écran, la correspondance entre le texte et l'illustration puisse être erronée sur l'impression papier.**
- **Si l'erreur passe inaperçue, on court le risque d'exécuter certaines opérations de manière incorrecte pouvant conduire à des dommages corporels et matériels.**

Comparez impérativement pour cette raison les impressions papier avec l'affichage à l'écran. Corrigez-les en cas d'erreur de manière à reproduire correctement l'affichage à l'écran.



#### ATTENZIONE

**Pericolo di perdita dell'abbinamento testo-immagine nella stampa.**

- **Per motivi tecnici non è escluso che, nonostante la rappresentazione sullo schermo risulti perfetta, durante la stampa venga persa la corrispondenza fra testo e relativa immagine.**
- **Se tale difetto non viene rilevato vi è il pericolo che i lavori non siano eseguiti correttamente; ciò può avere come conseguenza lesioni e danneggiamenti.**

Per questo motivo, dopo la stampa è assolutamente necessario confrontare le stampe con la rappresentazione sullo schermo. In caso di errore si prega di correggere le stampe, così da garantire la riproduzione esatta della rappresentazione sullo schermo.



#### ADVERTENCIA

**Al imprimir se corre el riesgo de perder la correcta asignación de las figuras al texto.**

- **Por motivos técnicos, por el momento no se puede descartar que, aun siendo correcta la imagen que aparezca en la pantalla, al imprimir se pierda la correlación entre el texto y la figura correspondiente.**
- **Si este error pasara desapercibido, existe el riesgo de que los trabajos no se ejecuten de forma correcta y, por tanto, se produzcan daños personales y materiales.**

Por ello le rogamos que tras el proceso de impresión compare siempre las copias impresas con la imagen de la pantalla. En caso de error, corrija las copias impresas de forma que se

Diagnostic system: reading out fault memory and activating systems correspondan con el contenido de la imagen de la pantalla.