

01.02.KB Right Side Front Wing Panel (Remove and Install New Part)

▣ WSM Data

▣ Included Procedures

▣ Is Used In

Removal

1. Remove the front right side wheel-arch liner (01.08.AN - Front Right Side Wheel-Arch Liner).

[\[Open Workshop Manual Procedure\]](#)

2. Apply protective tape to the body work adjacent to the front wing.
3. Release the cap for the filler neck from the windshield wash reservoir.

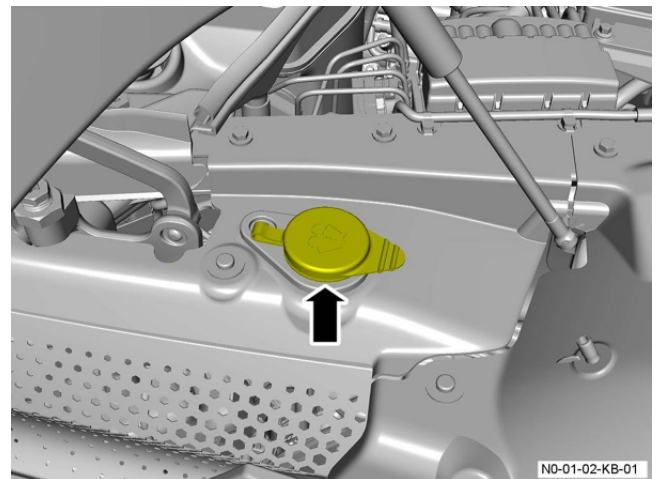

4. Remove the cap for the windshield wash filler.

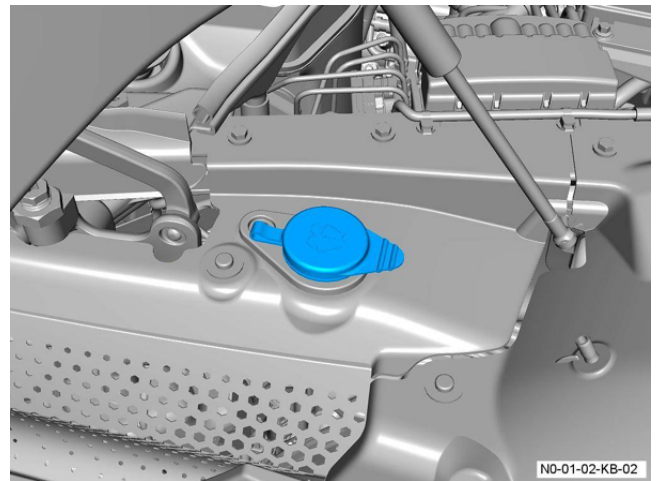

5. Remove the screw that attaches the windshield wash filler neck retention bracket to the rear headlamp mounting panel.

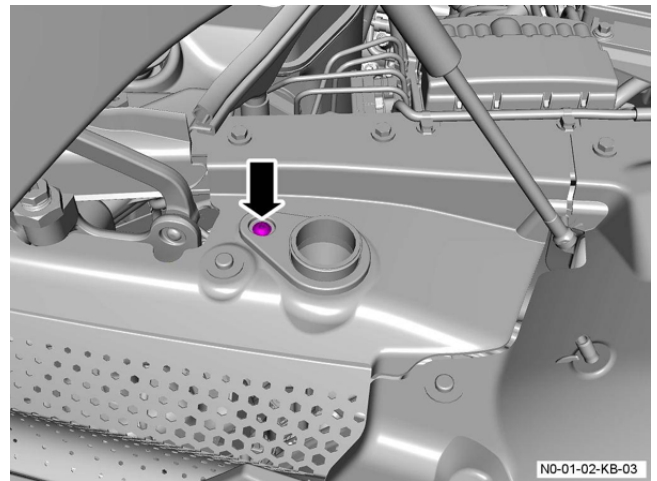

6. Release the bracket for the windshield wash filler-neck.

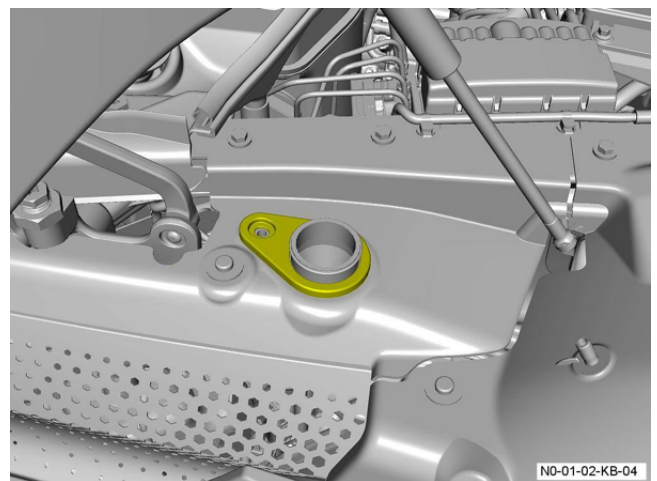

7. Remove the windshield wash filler-neck retention bracket.

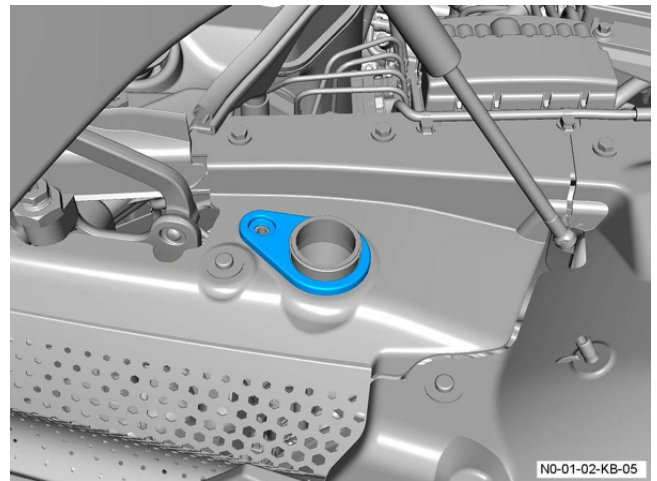

8. Remove the two bolts that attach the rear mounting panel for the headlamp to the front wing, collect the washers.

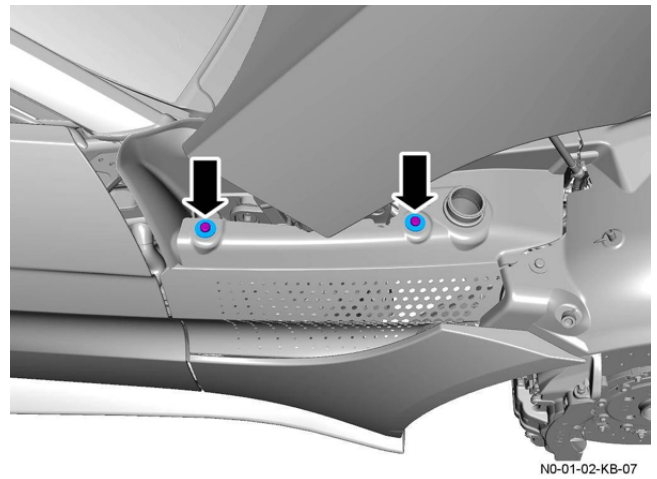

9. Remove the two bolts that attach the rear mounting panel for the headlamp to the body.

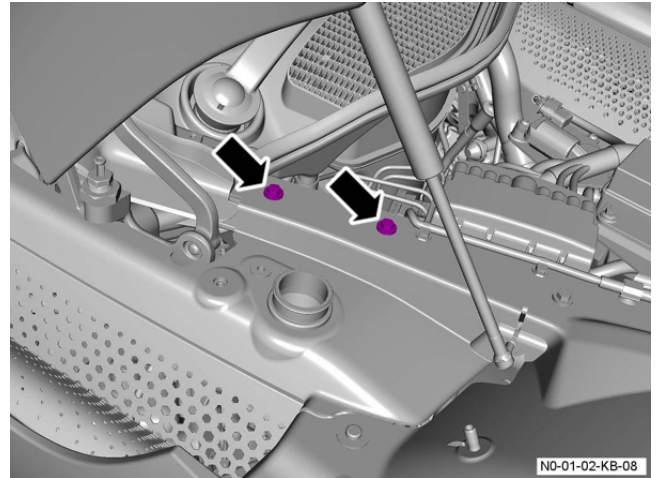

10. Release the hose clamp that attaches the screen-wash filler neck to the screen-wash filler tube.

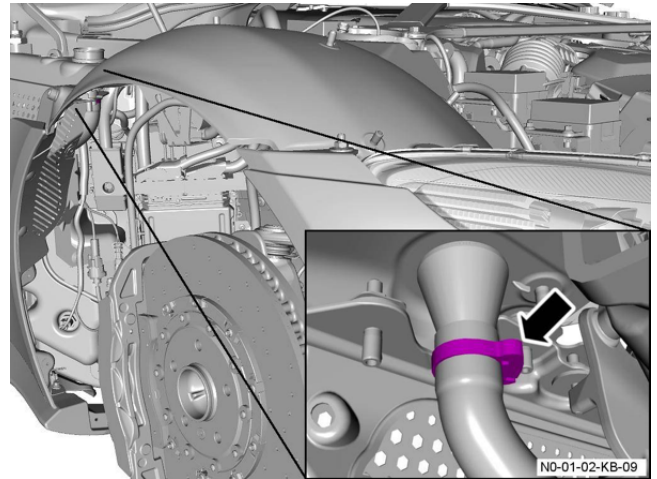

11. Release the screen-wash filler neck from the screen-wash filler tube.

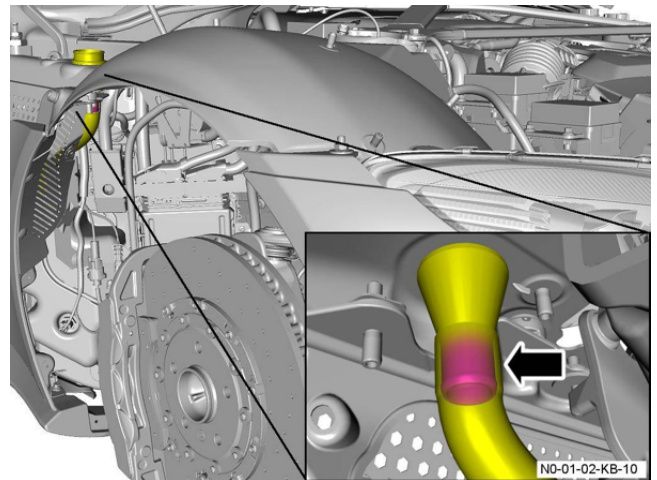

12. Remove the screen-wash filler neck.

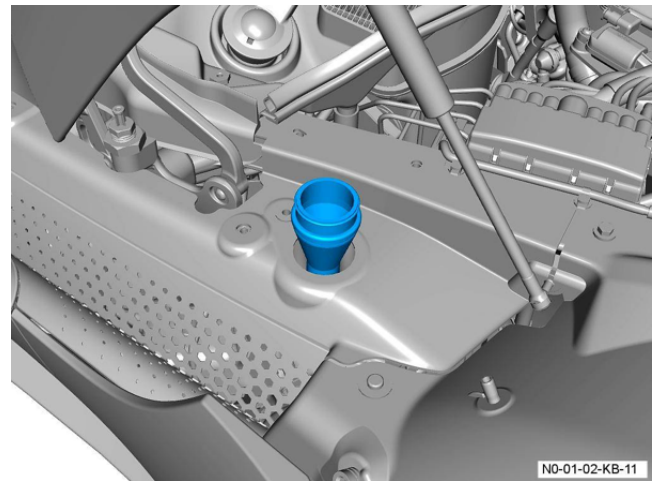

13. Release the rear mounting panel for the headlamp from the body.

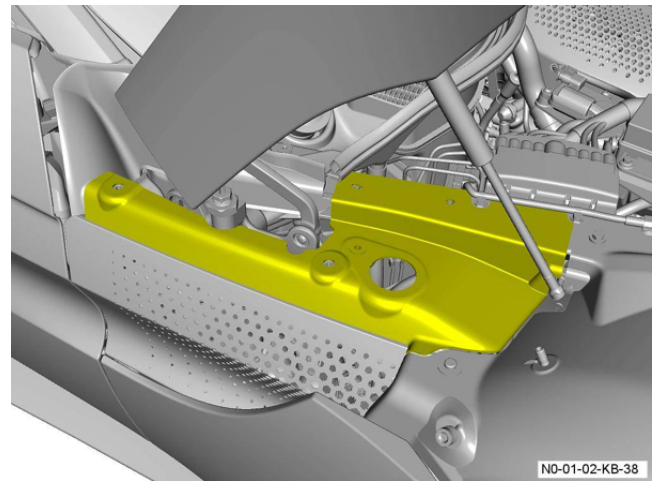

14. Remove the rear mounting panel for the headlamp.

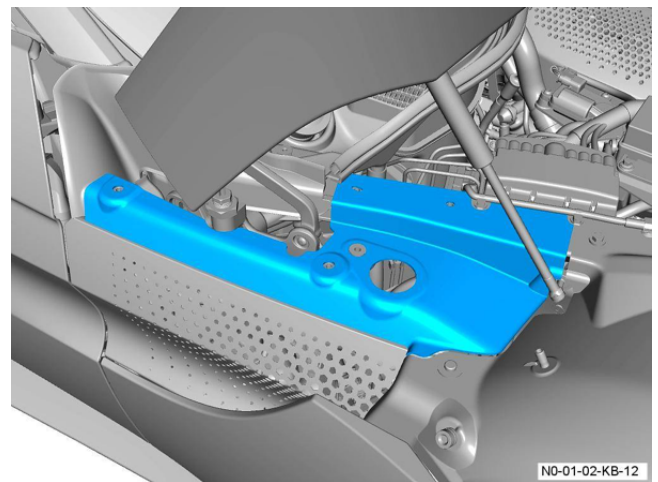

15. Remove the two nuts that attach the right side gill panel to the front wing and collect the washers.

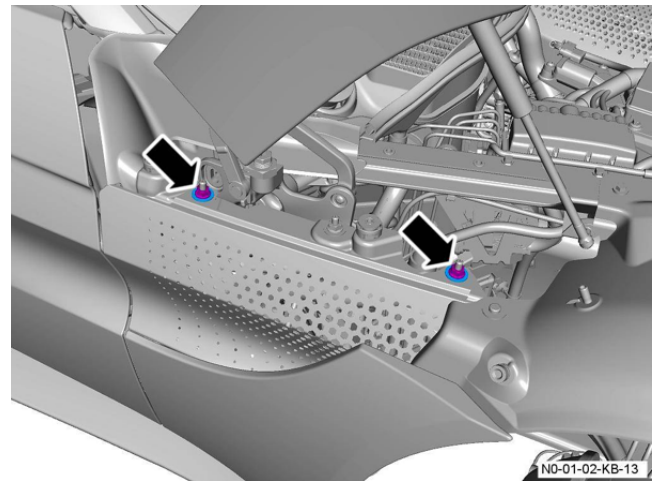

16. Release the right side gill panel from the front wing.

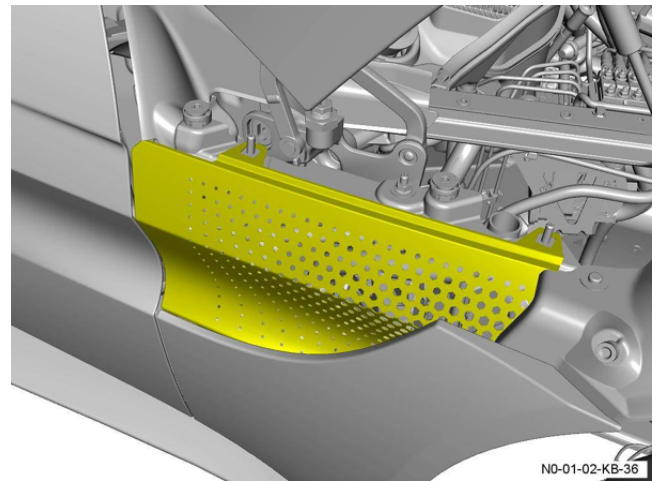

17. Remove the right side gill panel.

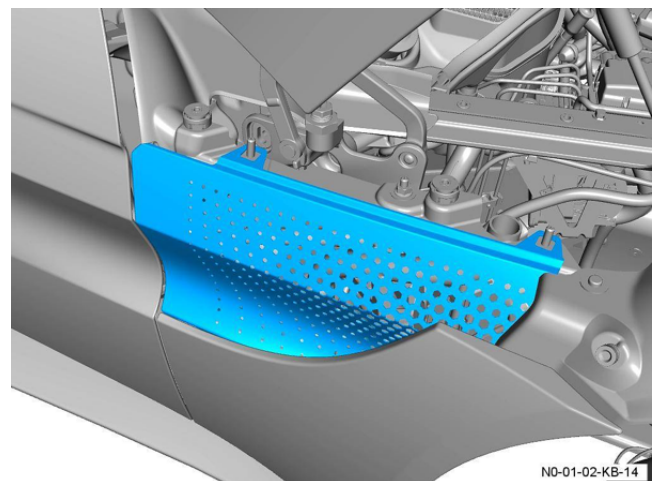

18. Remove the bolt that attaches the front wing to the right side sill blade assembly, collect the washer.

19. Remove and collect the spacer.

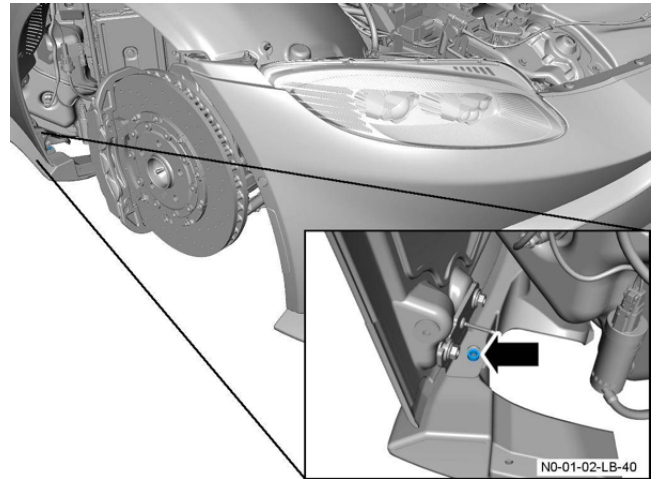
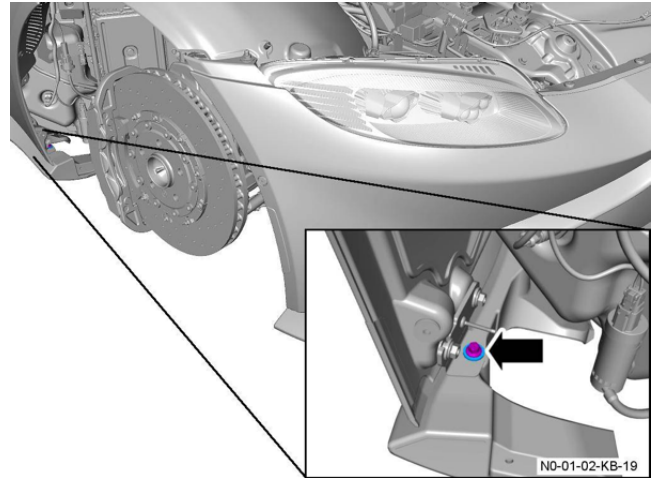

20. Open the right side door.
21. Remove the two bolts that attach the front wing to the body.

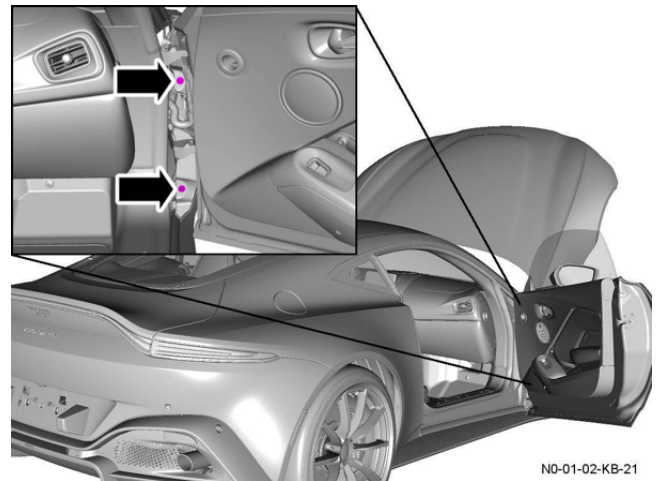

22. Remove the scrivet that attaches the leaf screen end assembly to the front wing.

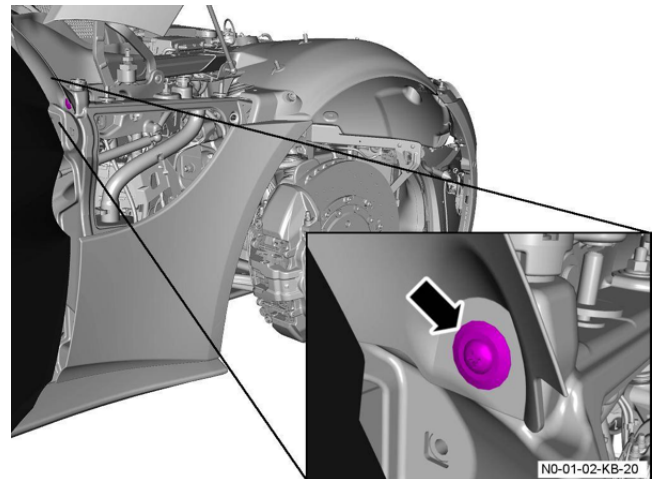

23. Remove the nut that attaches the front wing to the bonnet hinge assembly and collect the washer.

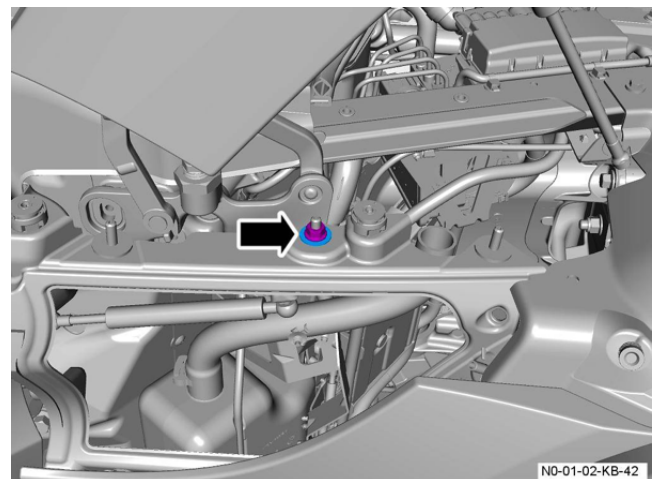

24. Release the front wing from the vehicle.

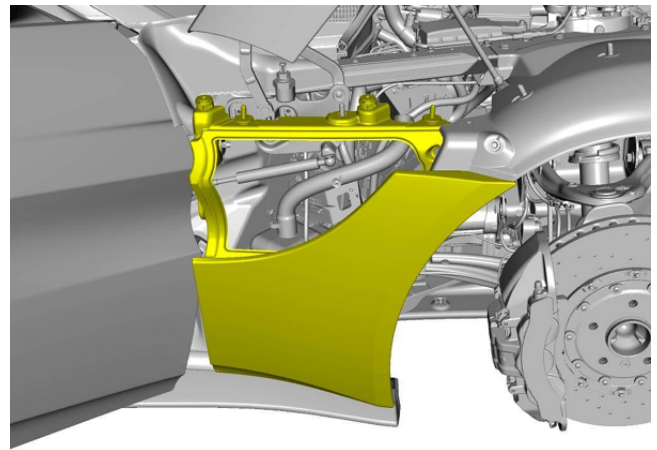

N0-01-02-KB-43

25. Remove the front wing.

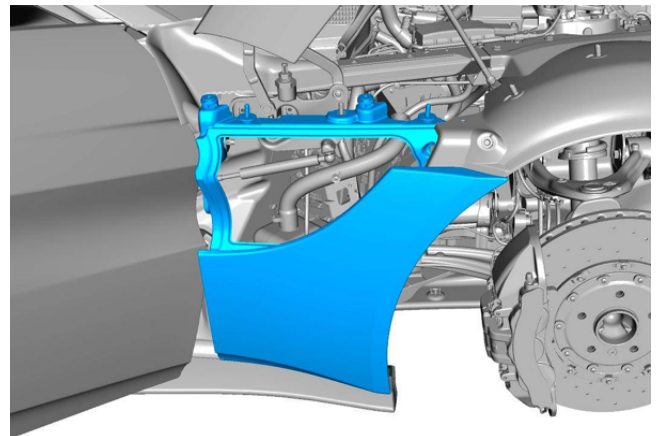

N0-01-02-KB-44

26.  *Note: If removal of the front wing is for access only, do not do the steps that follow.*

Remove the two double stud adjusters that attach the right side gill panel to the front wing.

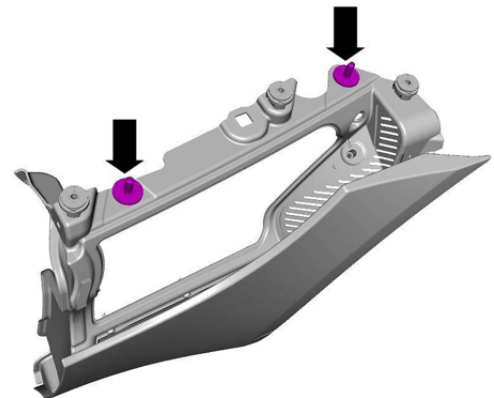

N0-01-02-KB-27

27. Remove the three rubber bumper mounts that are attached to the front wing.

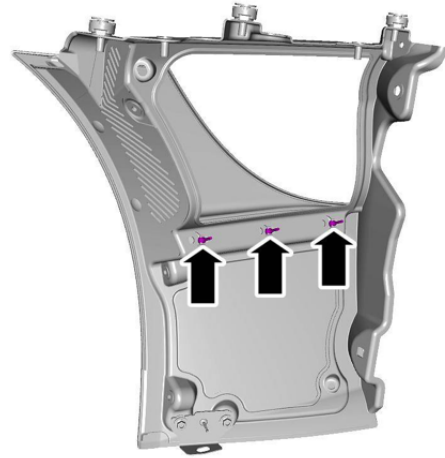

N0-01-02-KB-28

28. Remove the two clips that attach the wing slats to the front wing.

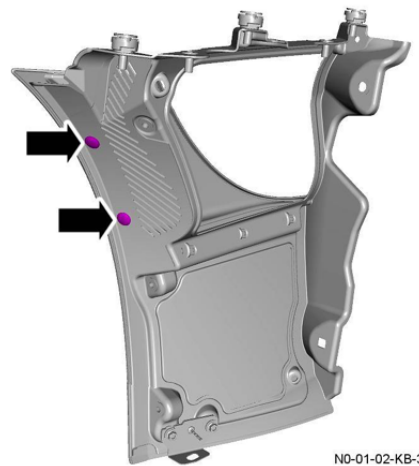

N0-01-02-KB-33

29. Release the wing slats from the front wing.



N0-01-02-KB-34

30. Remove the wing slats.



N0-01-02-KB-35

31. Remove the two nuts that attach the front wing to sill bracket to the front wing and collect the washers.

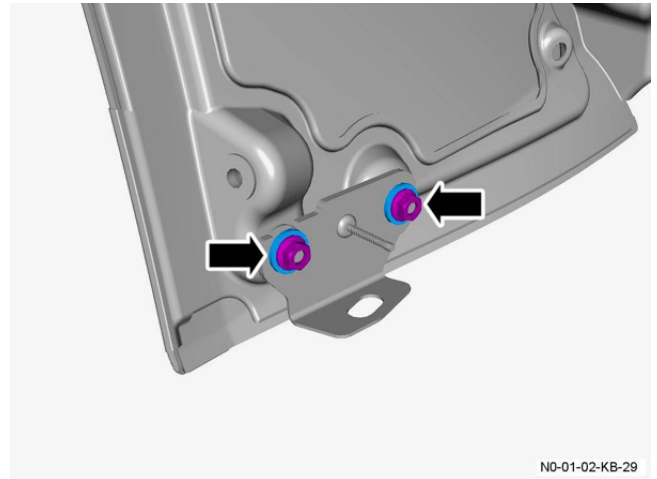

N0-01-02-KB-29

32. Release the front wing to sill bracket from the front wing.

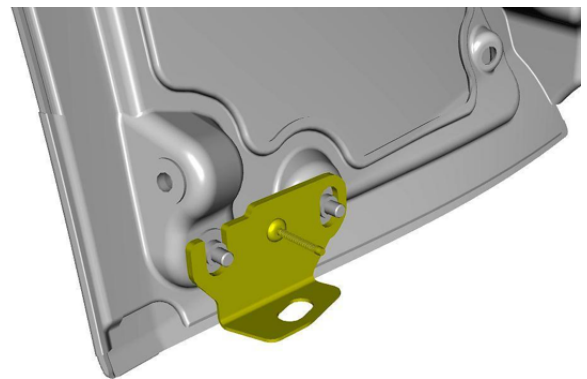

N0-01-02-KB-39

33. Remove the front wing to sill bracket.

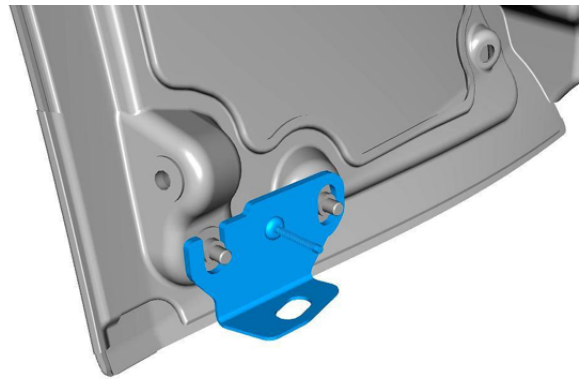

N0-01-02-KB-30

34. Remove and collect the two spacers.

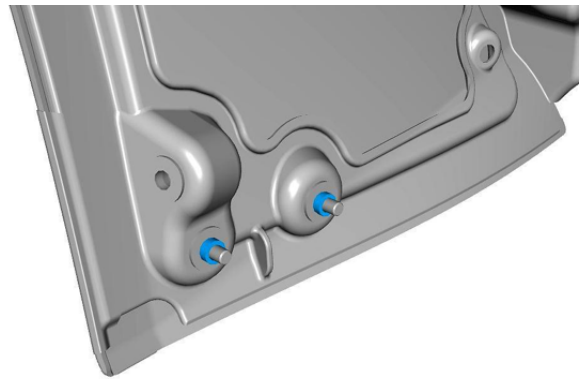

N0-01-02-KB-31

Install

1. Install a new strip of wing foam to the front wing.



N0-01-02-KB-32

2. Put the two spacers into position.

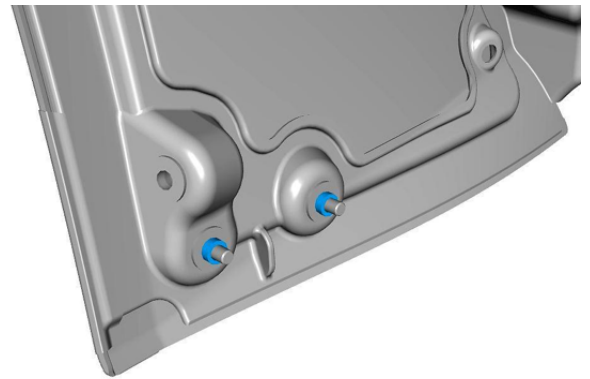

N0-01-02-KB-31

3. Put the front wing to sill bracket into position.

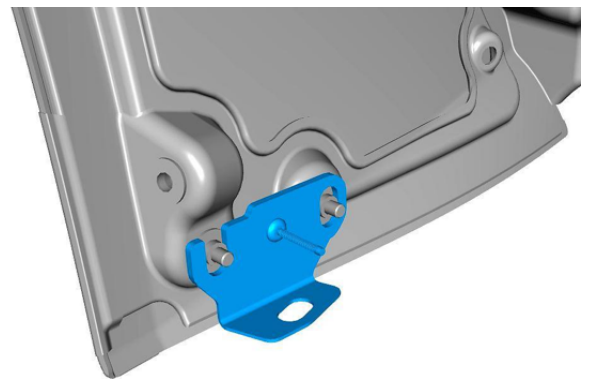

N0-01-02-KB-30

4. Install, but do not fully tighten, the two nuts and washers that attach the front wing to sill bracket to the front wing.

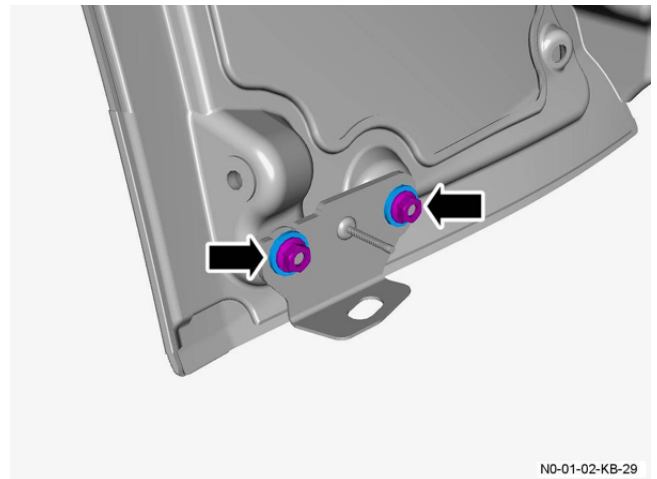

5. Put the wing slats into position.

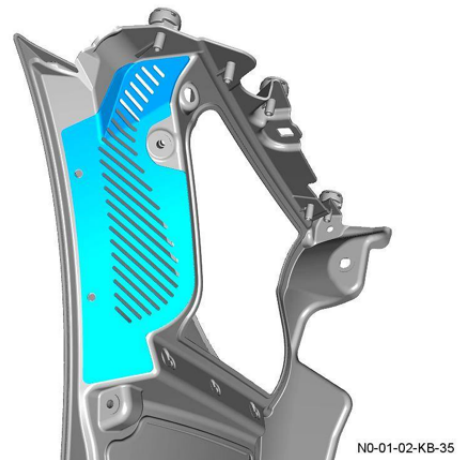

6. Install the two clips that attach the wing slats to the front wing.

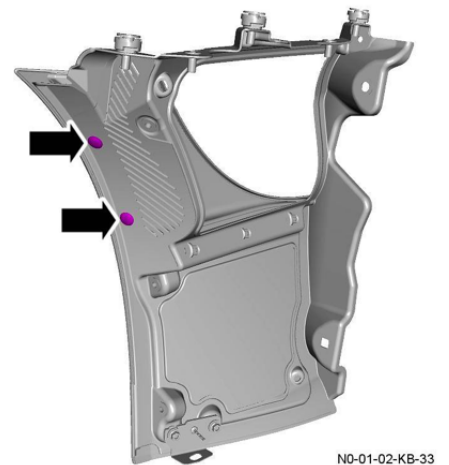

7. Install the three rubber bumper mounts to the front wing.

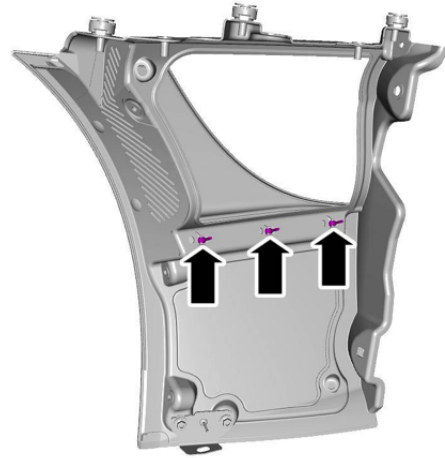

N0-01-02-KB-28

8. Install, but do not fully tighten, the two double stud adjusters that attach the right side gill to the front wing.

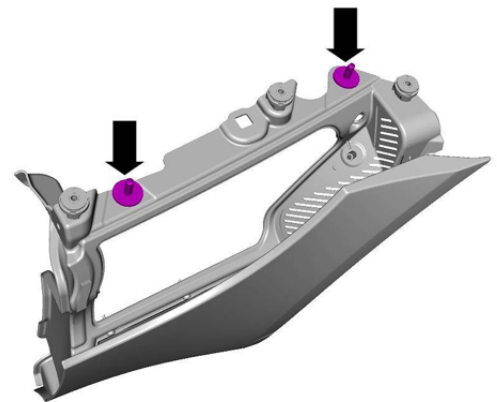

N0-01-02-KB-27

9. Carefully put the front wing into position.

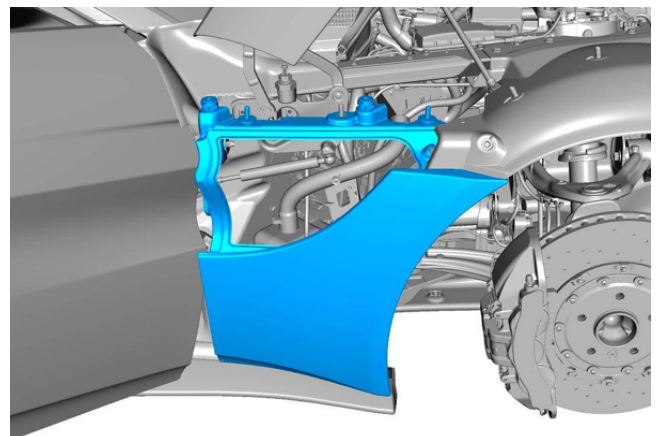

N0-01-02-KB-44

10. Install, but do not fully tighten, the nut and washer that attach the front wing to

the bonnet hinge assembly.

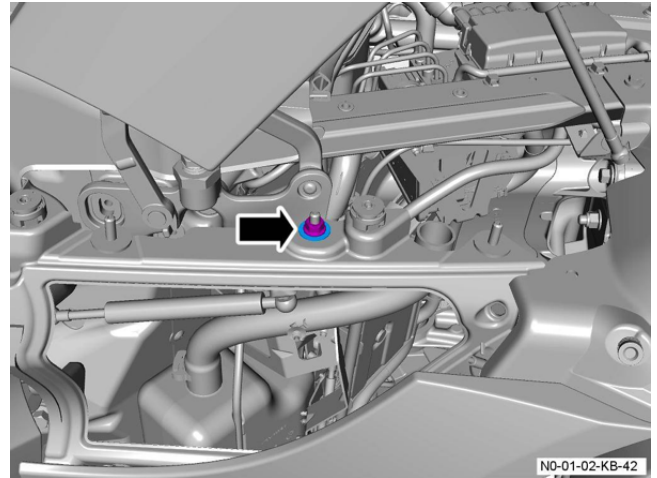

11. Install, but do not fully tighten, the two bolts that attach the front wing to the body.

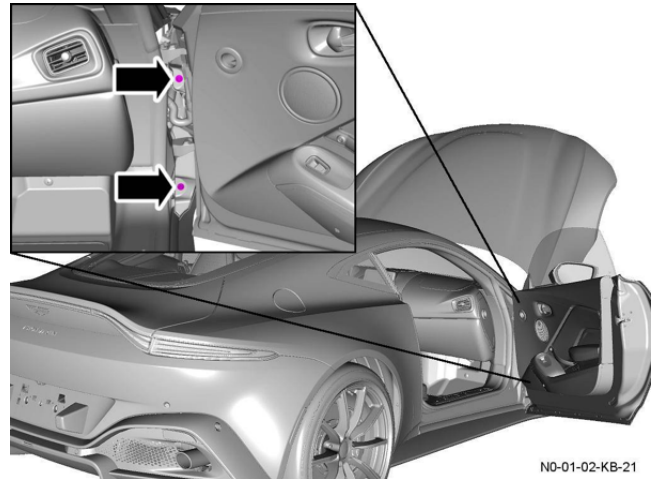

12. Put the spacer into position.

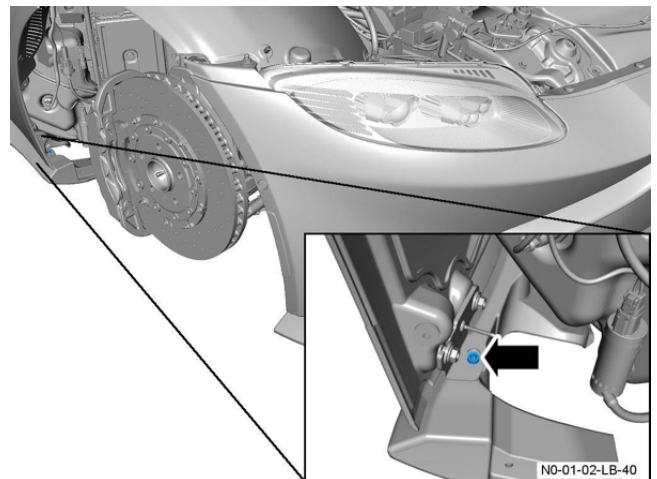

13. Install, but do not fully

tighten, the bolt that attaches the front wing to the right side sill blade assembly.

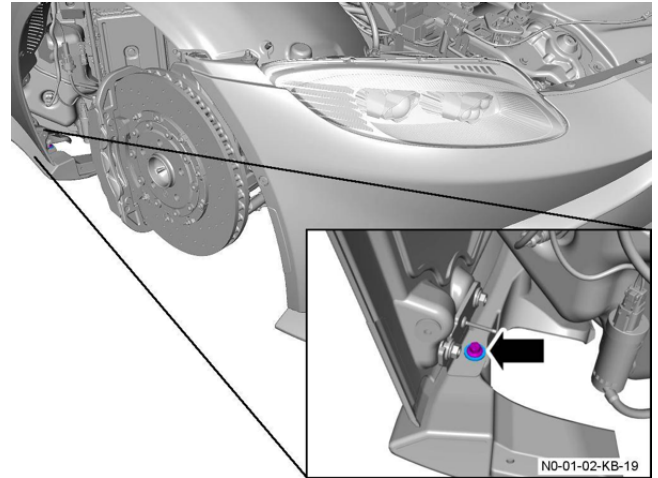

14. Carefully close the door and the bonnet.
15. Align the front wing panel correctly to the adjacent body panels.

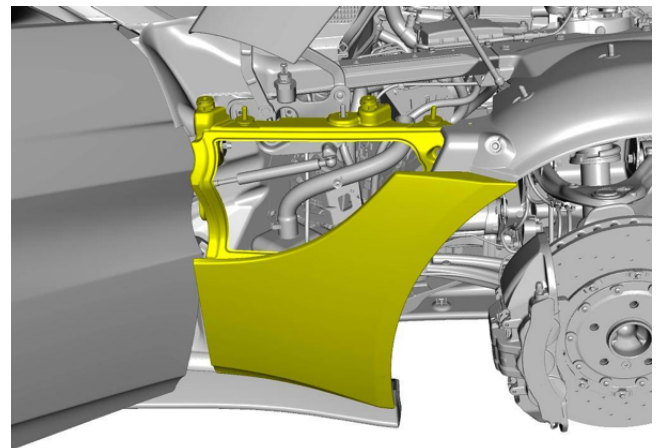

16. The image shows the measurement points for which the applicable

specifications are:

- ▶ **Fender to door (points 2 and 3)**

- ▶ *Gap:*

- ▶ Minimum = 4.0mm

- ▶ Maximum = 5.0mm

- ▶ *Flush:*

- ▶ Minimum = 0mm

- ▶ Nominal = 0mm

- ▶ Maximum = 0.75mm

- ▶

- ▶ **Feature line alignment (point 1)**

- ▶ *Flush:*

- ▶ Minimum = -0.75mm

- ▶ Nominal = 0mm

- ▶ Maximum = 0.75mm

- ▶

- ▶ **Bonnet to fender (points 4 and 5)**

- ▶ *Gap:*

- ▶ Minimum = 2.5mm

- ▶ Nominal = 4.0mm

- ▶ Maximum = 4.5mm

- ▶ *Flush:*

- ▶ Minimum = -1.5mm

- ▶ Nominal = 0mm

- ▶ Maximum = 0mm

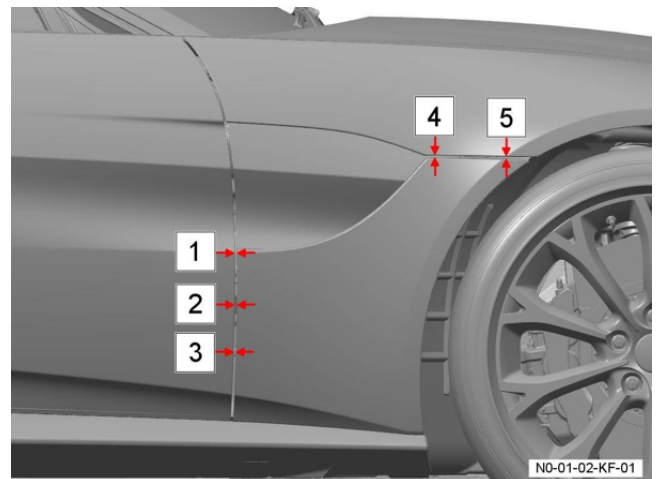

17. The image shows the measurement points for which the applicable specifications are:

▶ **Fender to bonnet (points 6 and 8)**

▶ *Gap:*

- ▶ Minimum = 4.0mm
- ▶ Nominal = 4mm
- ▶ Maximum = 5.0mm

▶ *Flush:*

- ▶ Minimum = 0mm
- ▶ Nominal = 0mm
- ▶ Maximum = 0.75mm

▶

▶ **Feature line alignment (point 7)**

▶ *Flush:*

- ▶ Minimum = -0.75mm
- ▶ Nominal = 0mm
- ▶ Maximum = 0.75mm

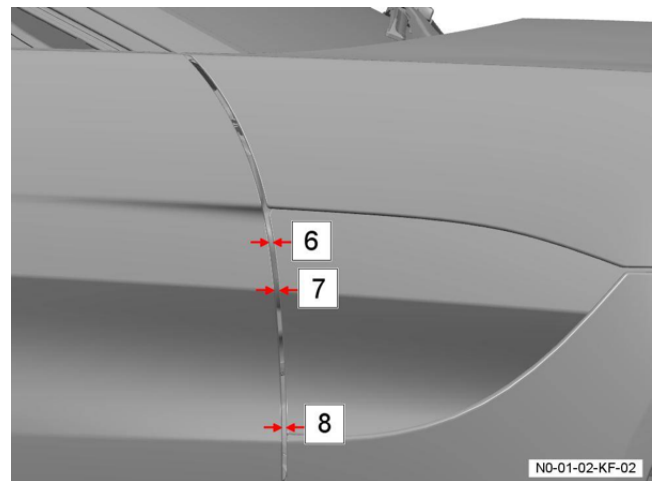

18. Carefully open the bonnet and door.

19. Tighten the bolt that attaches the front wing to the right side sill blade assembly.

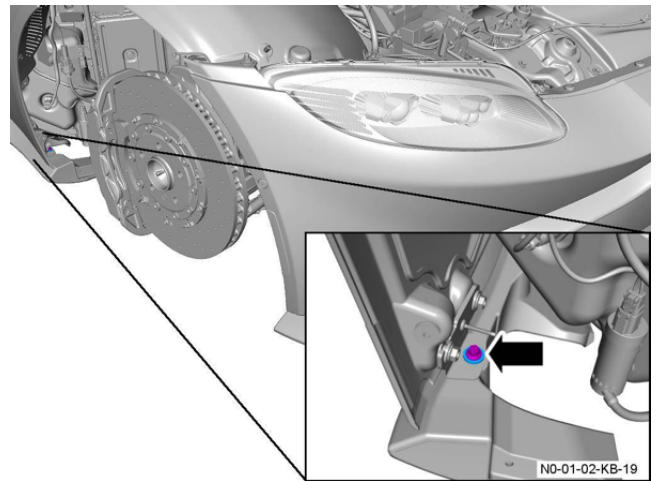

20. Tighten the two nuts that attach the front wing to sill bracket to the front wing.

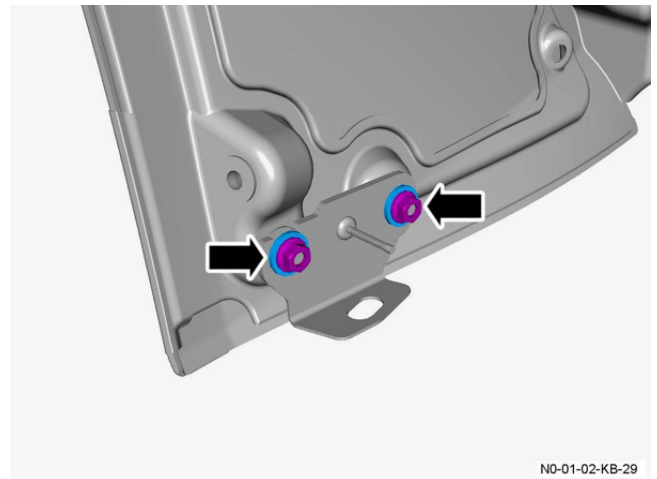

21. Tighten the two bolts that attach the front wing to the body.

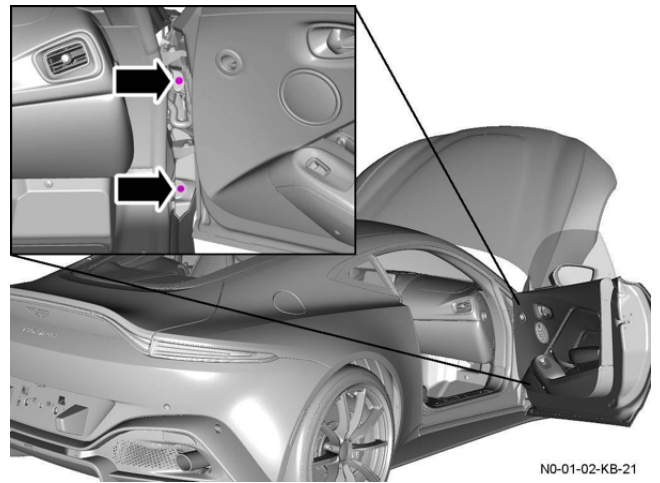

22. Tighten the nut that attaches the front wing to the bonnet hinge assembly.

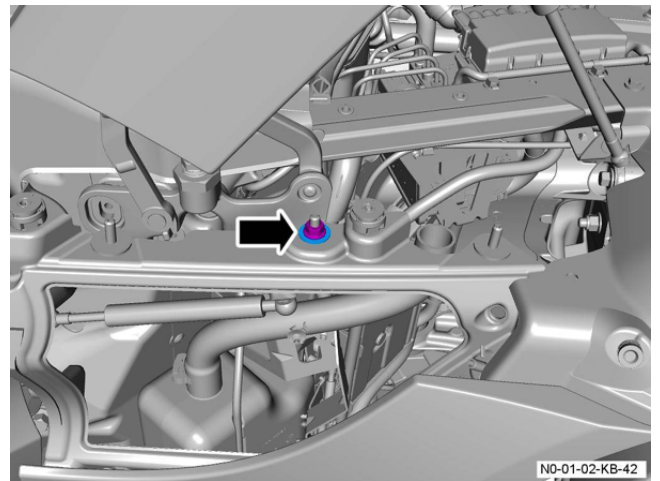

23. Install the scrivet that attaches the leaf screen end assembly to the front wing.

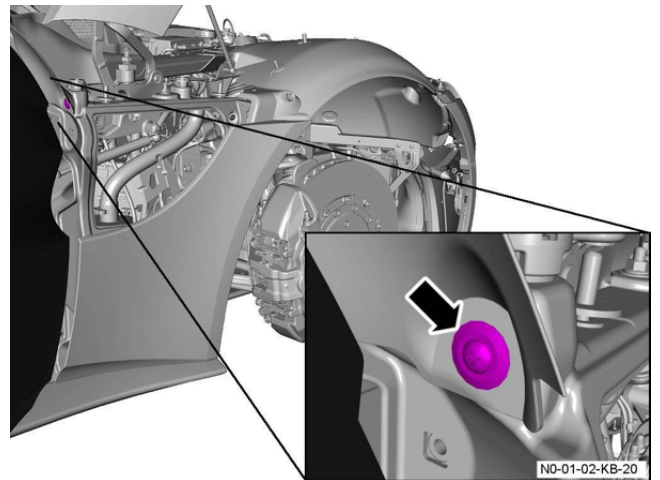

24. Install and tighten, the bolt and washer that attach the right side headlamp mounting panel to the front wing.

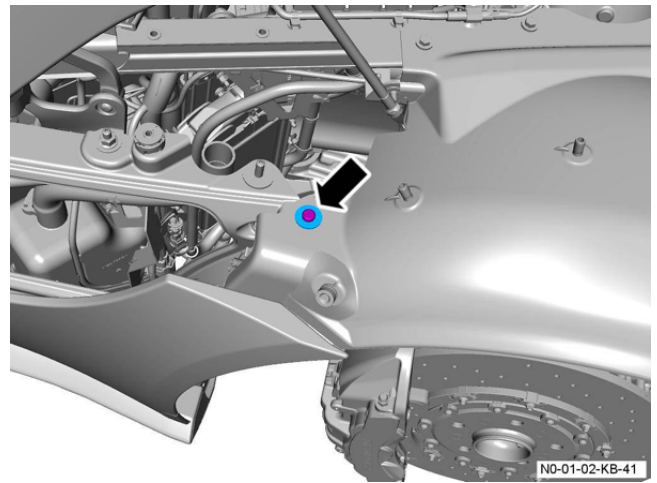

25. Put the right side gill in to position.

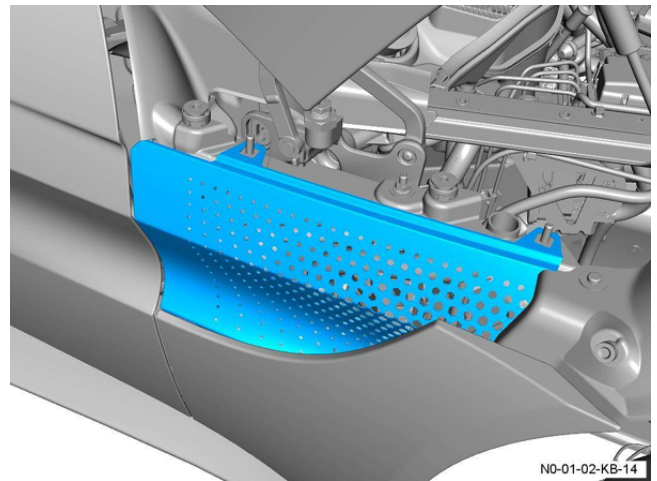

26. Install, but do not tighten, the two nuts and washers that attach the right side gill to the front wing.

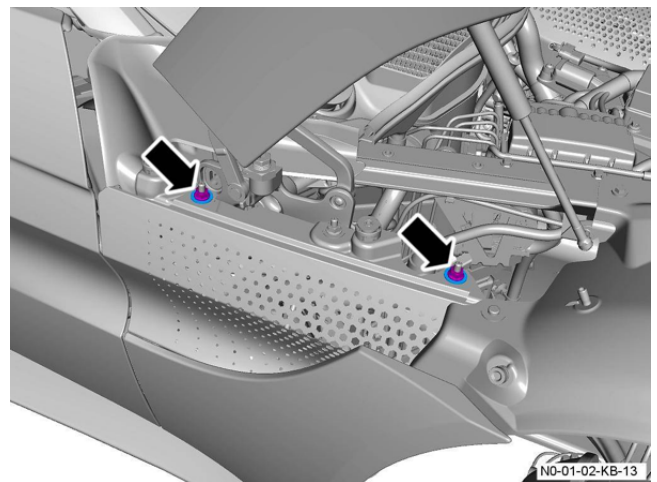

27. Align the right side gill panel correctly to the adjacent body panels.

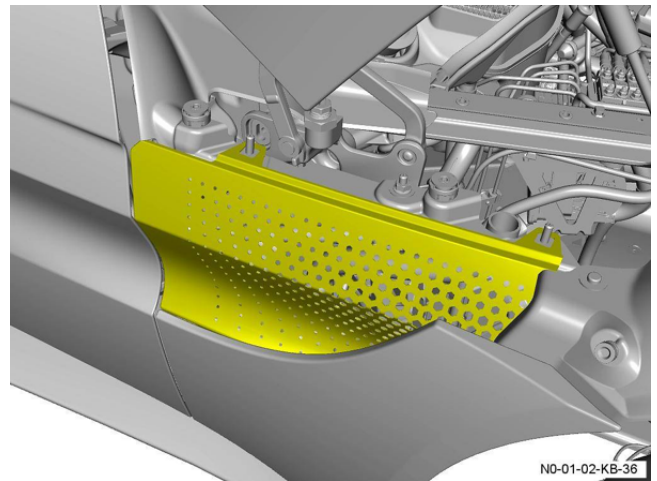

N0-01-02-KB-36

28. Tighten the two nuts that attach the right side gill to the front wing.

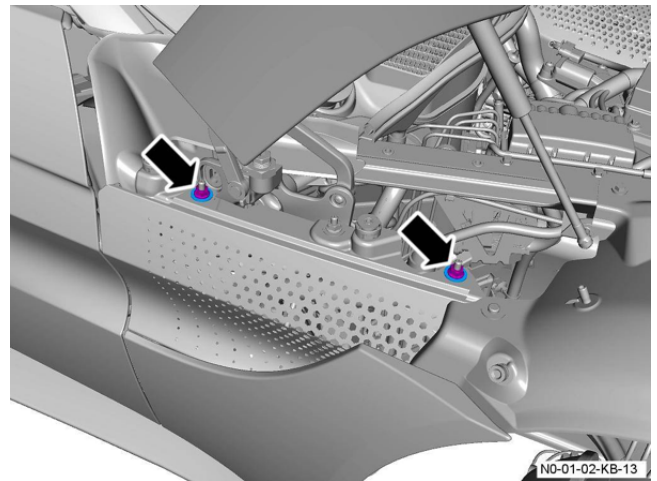

N0-01-02-KB-13

29. Put the rear headlamp mounting panel into position.

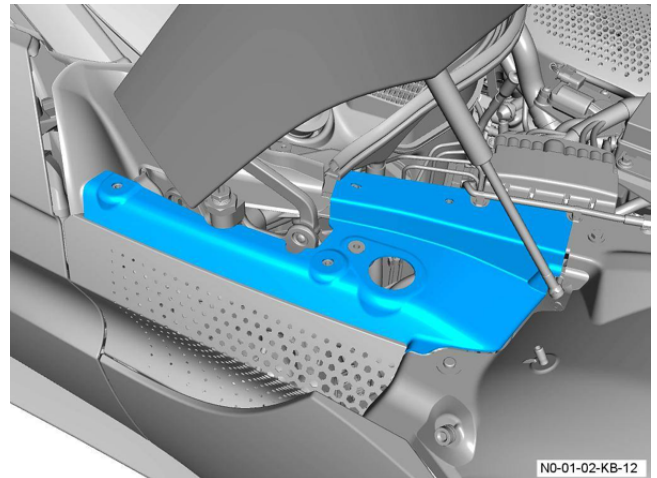

N0-01-02-KB-12

30. Put the screen-wash filler neck into position.

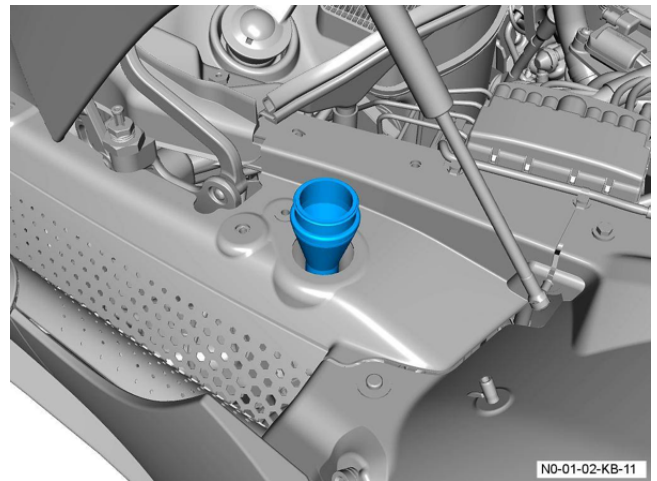

31. Install the screen-wash filler neck to the screen-wash filler tube.

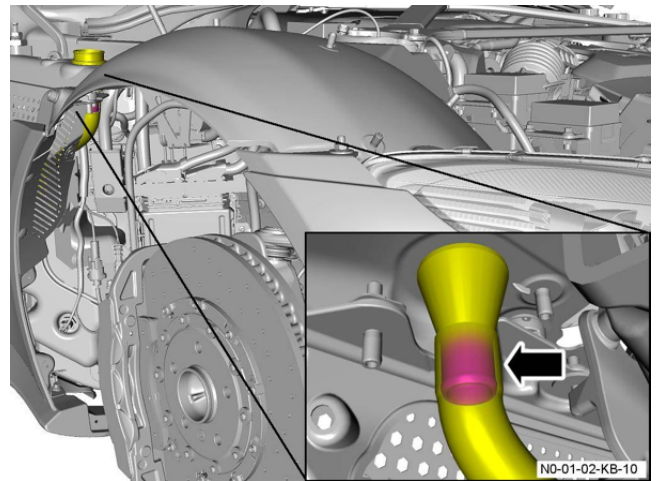

32. Install the hose clamp that attaches the screen-wash filler neck to the screen-wash filler tube.

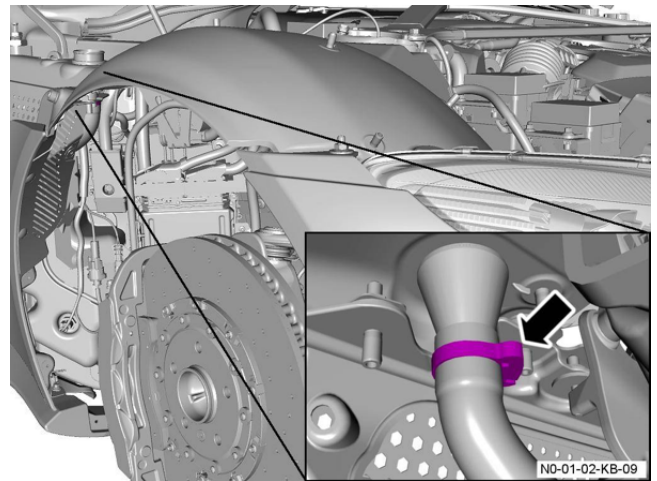

33. Install and tighten the two bolts that attach the rear headlamp mounting panel to the body.

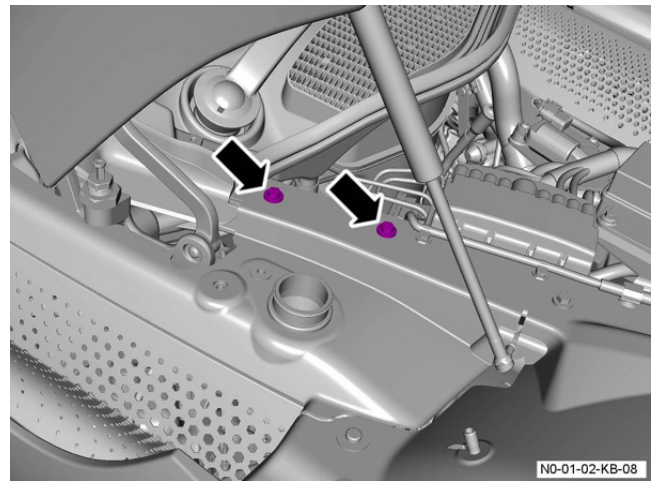

34. Install and tighten, the two bolts and washers that attach the rear headlamp mounting panel to the front wing.

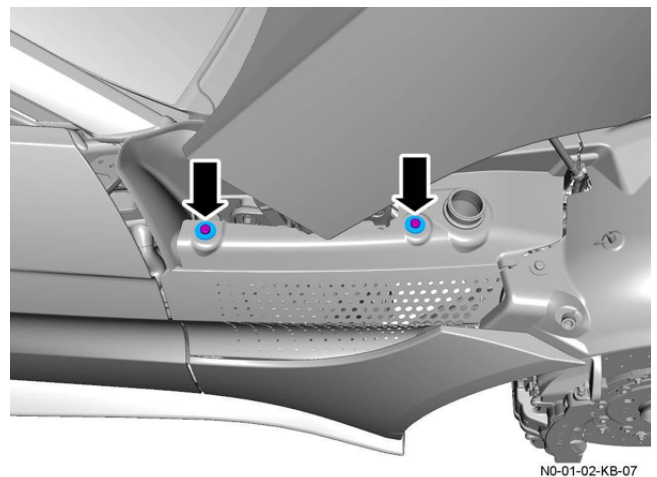

35. Put the screen-wash filler neck retention bracket into position.

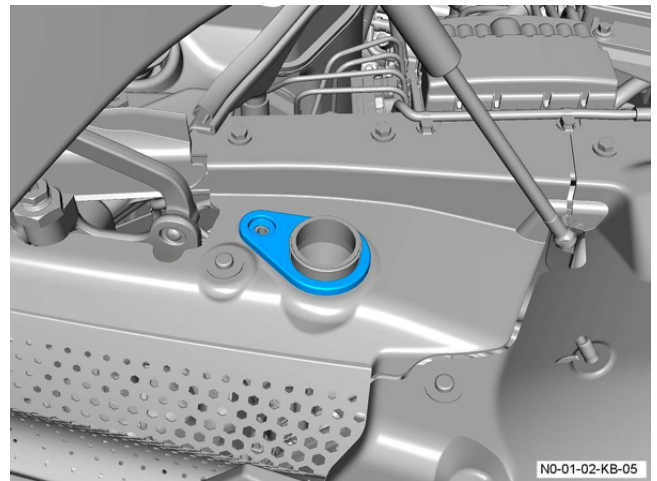

36. Install the screen-wash filler neck retention bracket to the screen-wash filler neck.

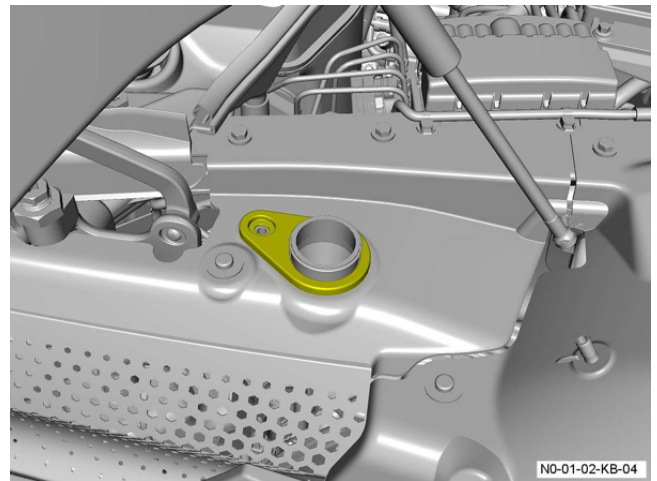

37. Install and tighten the screw that attaches the screen-wash filler neck retention bracket to the rear headlamp mounting panel.

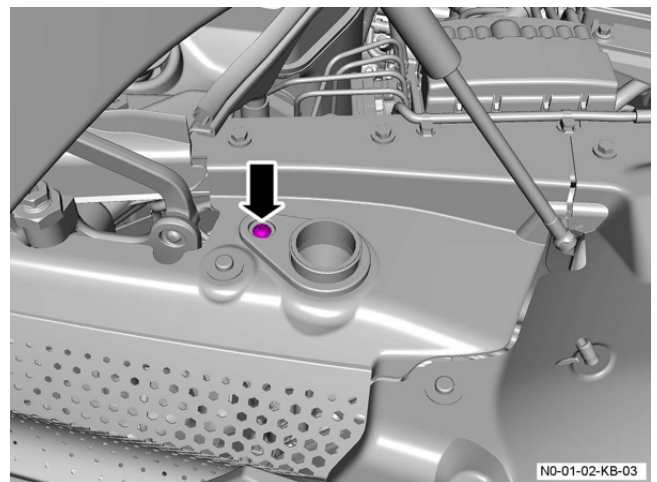

38. Put the screen-wash filler cap into position.

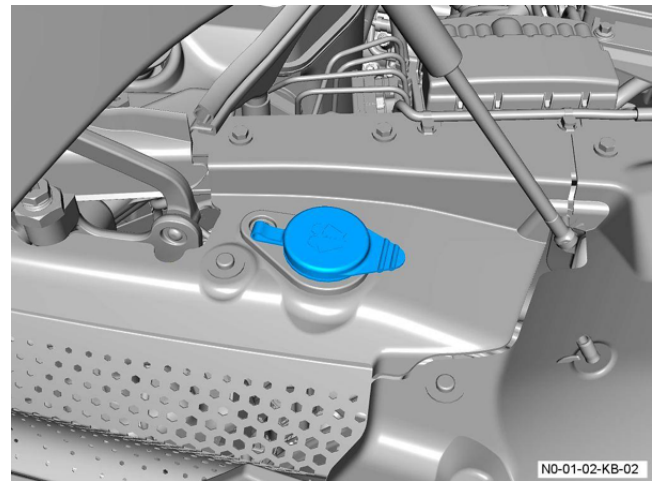

39. Install the screen-wash filler cap to the screen-wash filler neck.

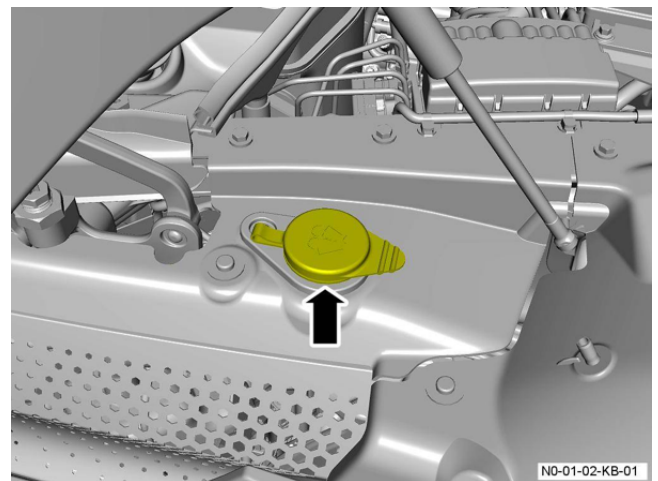

40. Remove the protective tape from the body work adjacent to the front wing.
41. Install the Front Right Side Wheel-Arch Liner Assembly (01.08.AN - Front Right Side Wheel-Arch Liner).
[Open Workshop Manual Procedure]
42. Installation is the opposite of the removal sequence.

